



RIALTO COMMUNITY CENTER

BUILDINGS 200, 300, 400, & 500

rehabilitation



RIALTO
COMMUNITY SERVICES

214 N. Palm Avenue, Rialto, California 92376



IDS GROUP

1 PETERS CANYON ROAD, SUITE 130
IRVINE, CA 92606

www.idsgi.com

TEL: 949-387-8500, FAX: 949-387-0800

11.01.2017

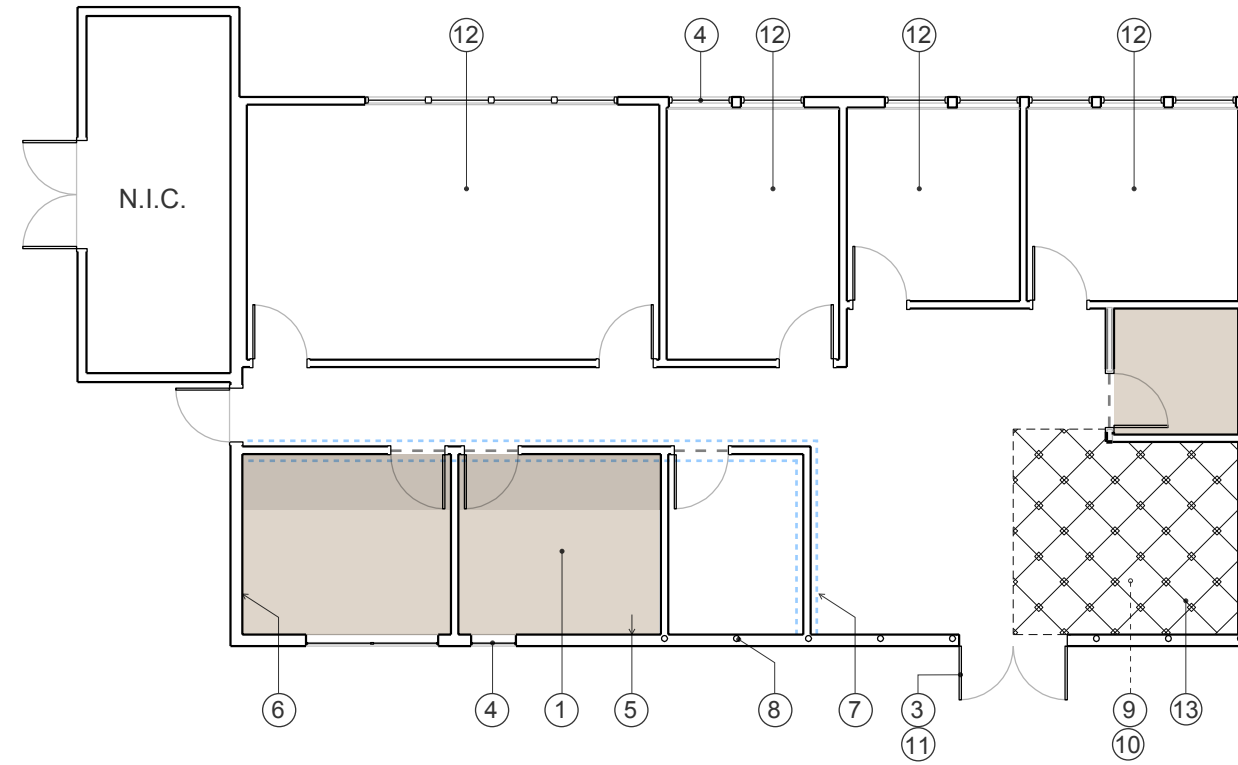

BUILDING 200
(room 204)

LEGEND

- | | | |
|---|--------------------------------|-------------------------------|
| ① new vinyl composite tile flooring (VCT) | ⑥ new primary paint color, P2 | ⑪ new storefront door |
| ② new epoxy floor coating w/ coved base | ⑦ new accent paint color, A1 | ⑫ existing flooring to remain |
| ③ new panic device* | ⑧ new accent paint color, A2 | ⑬ new tile to match existing |
| ④ new storefront window system, typical | ⑨ new suspended ceiling system | |
| ⑤ new primary paint color, P1 | ⑩ new 2x4 LED light fixture | |

*as required by code

NOTES

1. existing acoustic ceiling tiles to be removed
2. existing surface mounted lights to be removed
3. all interior walls to be prepared and painted
4. all interior walls to be painted 'P1' U.N.O.
5. at area of tile patch, remove existing adjacent tile back nearest full tile to create a seamless appearance

RIALTO COMMUNITY CENTER

representational floor plan 



client: CITY OF RIALTO
335 W Rialto Avenue
Rialto, CA 92376

project address: 214 N Palm Avenue
Rialto, CA 92376

date: 2017.11.01

project no: 17X082.00

scale: 3/32" = 1'-0"

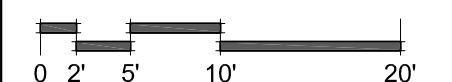

1 Peters Canyon Road, Suite 130
Irvine, CA 92606
Tel: 949-367-8500 Fax: 949-367-0800

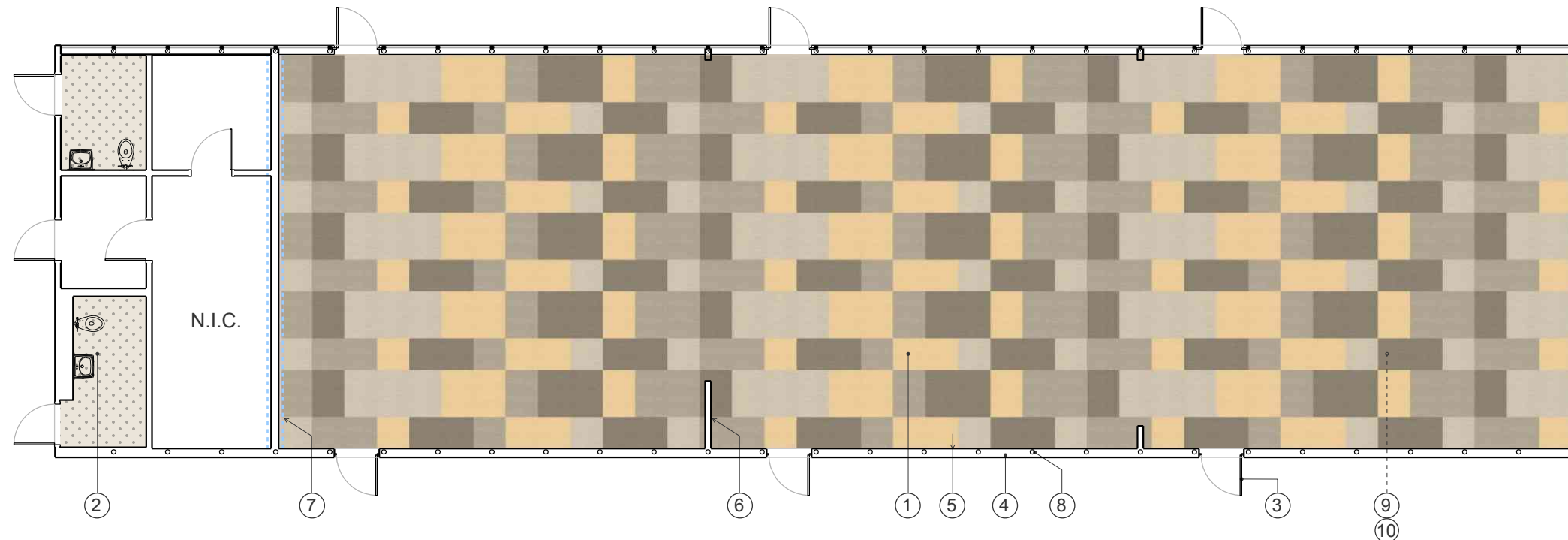

BUILDING 200
(rooms 201 - 203)

LEGEND

- ① new vinyl composite tile flooring (VCT)
- ② new epoxy floor coating w/ coved base
- ③ new panic device*
- ④ new storefront window system, typical
- ⑤ new primary paint color, P1
- ⑥ new primary paint color, P2
- ⑦ new accent paint color, A1
- ⑧ new accent paint color, A2
- ⑨ new drywall ceiling system
- ⑩ new pendant LED light fixtures

*as required by code

NOTES

1. existing acoustic ceiling tiles to be removed
2. existing surface mounted lights to be removed
3. all interior walls to be prepared and painted
4. all interior walls to be painted 'P1' U.N.O.
5. patch (e) flooring where wall removed
6. existing window area to be reduced

RIALTO COMMUNITY CENTER

representational floor plan



client: CITY OF RIALTO
335 W Rialto Avenue
Rialto, CA 92376

project address: 214 N Palm Avenue
Rialto, CA 92376

date: 2017.11.01

project no: 17X082.00

scale: 3/32" = 1'-0"

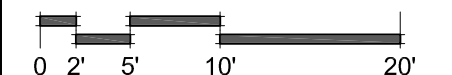

1 Peters Canyon Road, Suite 130
Irvine, CA, 92606
Tel: 949-387-8500 Fax: 949-387-0800

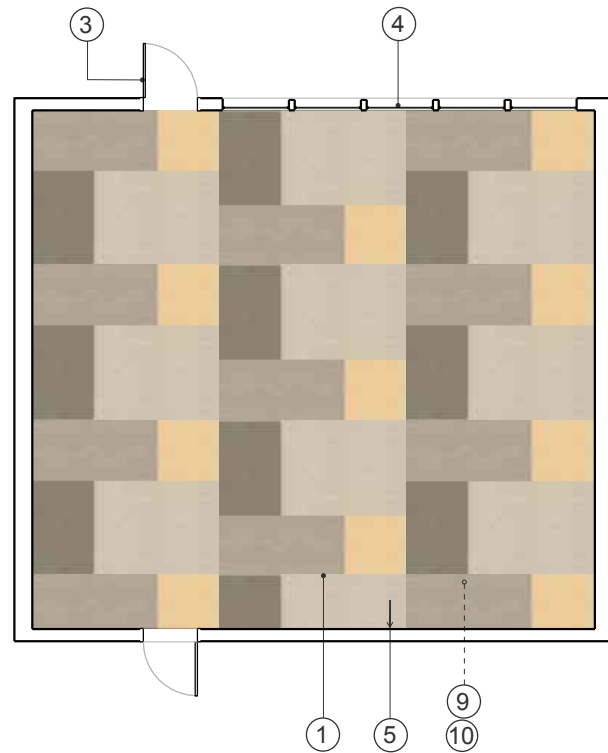

BUILDING 300
(room 306)

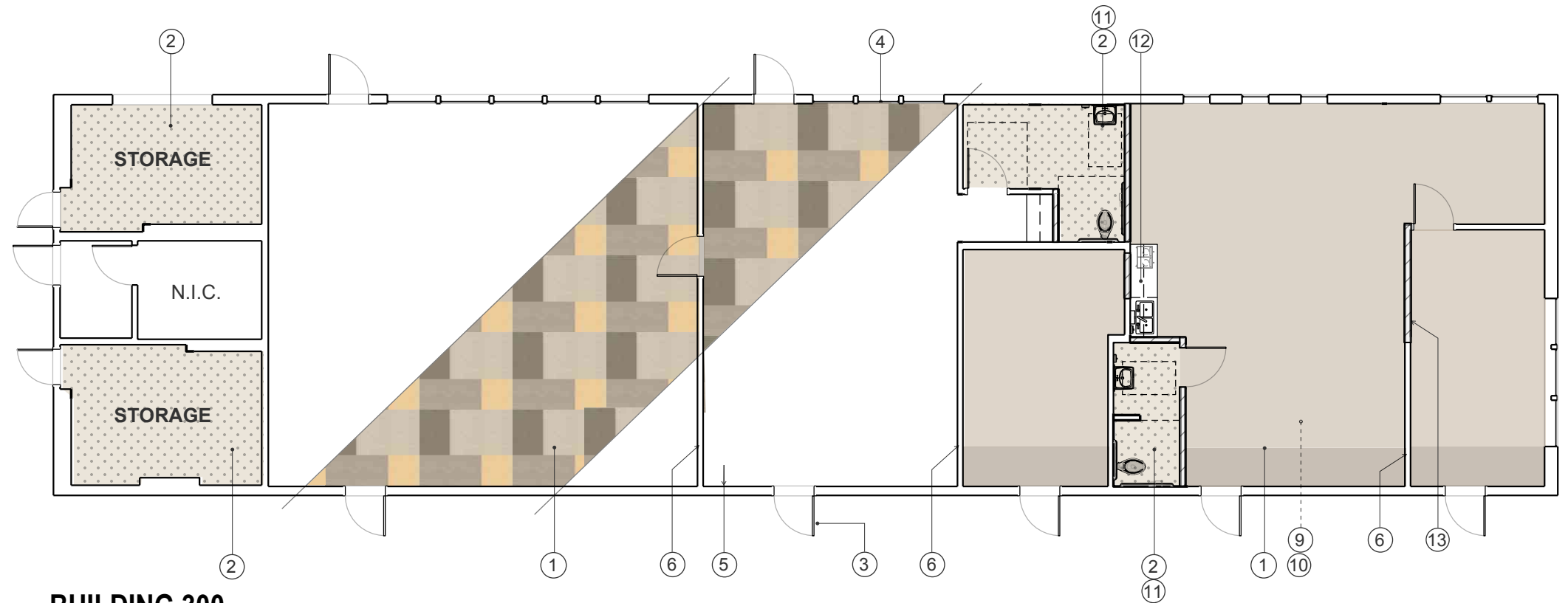

BUILDING 300
(rooms 301 - 305)

LEGEND

- | | | |
|---|--------------------------------|---------------------------------|
| ① new vinyl composite tile flooring (VCT) | ⑥ new primary paint color, P2 | ⑪ new ADA compliant toilet room |
| ② new epoxy floor coating w/ coved base | ⑦ new accent paint color, A1 | ⑫ new kitchenette |
| ③ new panic device* | ⑧ new accent paint color, A2 | ⑬ new wall / infill |
| ④ new storefront window system | ⑨ new suspended ceiling system | |
| ⑤ new primary paint color, P1 | ⑩ new 2x4 LED light fixture | |

*as required by code

NOTES

- existing acoustic ceiling tiles to be removed
- existing surface mounted lights to be removed
- all interior walls to be prepared and painted
- all interior walls to be painted 'P1' U.N.O.
- existing interior accessed toilet rooms to be made ADA compliant
- existing exterior accessed toilet rooms to be converted to storage

RIALTO COMMUNITY CENTER

representational floor plan 

logo:



client: CITY OF RIALTO
335 W Rialto Avenue
Rialto, CA 92376

project address: 214 N Palm Avenue
Rialto, CA 92376

date: 2017.11.01

project no: 17X082.00

scale: 3/32" = 1'-0"

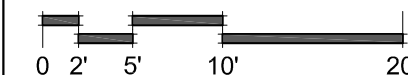

IDS GROUP
1 Peters Canyon Road, Suite 130
Irvine, CA 92606
Tel: 949-387-8500 Fax: 949-387-0800

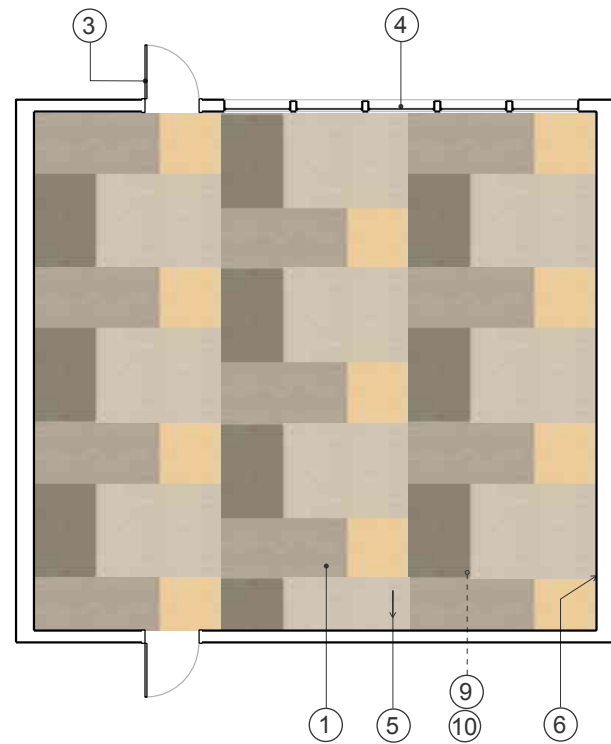

BUILDING 400
(room 404)

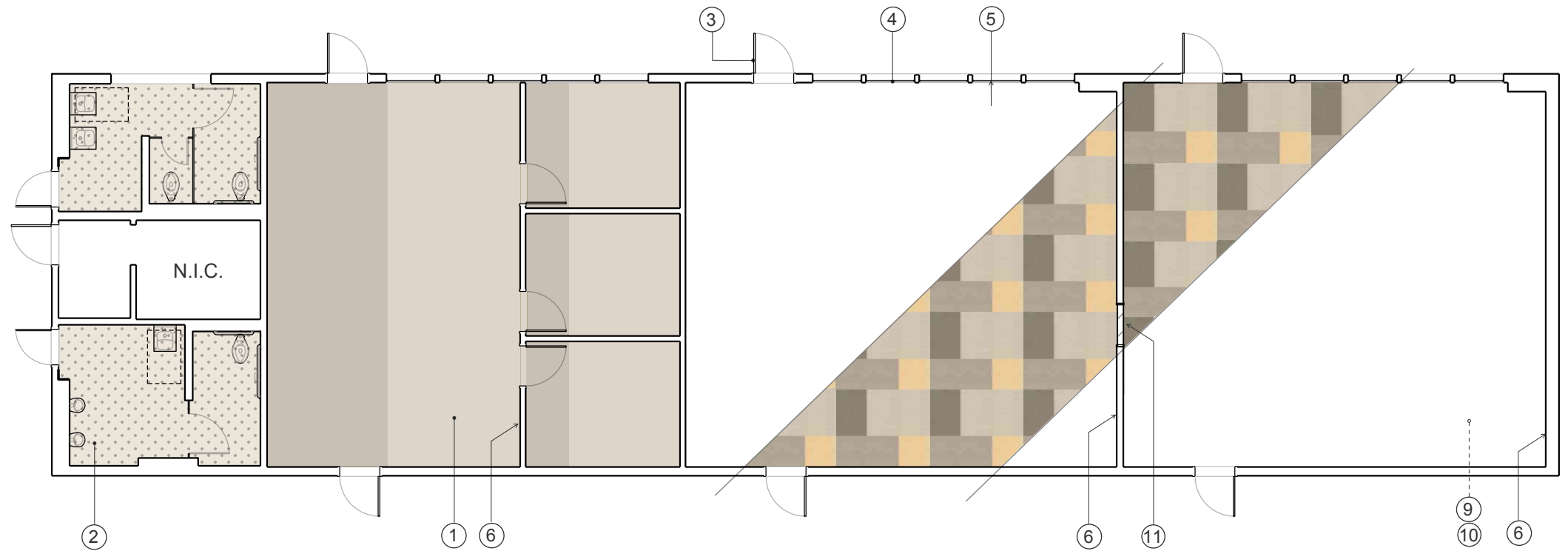

BUILDING 400
(rooms 401 - 403)

LEGEND

- ① new vinyl composite tile flooring (VCT)
- ② new epoxy floor coating w/ coved base
- ③ new panic device*
- ④ new storefront window system
- ⑤ new primary paint color, P1
- ⑥ new primary paint color, P2
- ⑦ new accent paint color, A1
- ⑧ new accent paint color, A2
- ⑨ new suspended ceiling system
- ⑩ new 2x4 LED light fixture
- ⑪ new wall / infill

*as required by code

NOTES

1. existing acoustic ceiling tiles to be removed
2. existing surface mounted lights to be removed
3. all interior walls to be prepared and painted
4. all interior walls to be painted 'P1' U.N.O.
5. existing window area to be reduced

RIALTO COMMUNITY CENTER

representational floor plan



client: CITY OF RIALTO
335 W Rialto Avenue
Rialto, CA 92376

project address: 214 N Palm Avenue
Rialto, CA 92376

date: 2017.11.01

project no: 17X082.00

scale: 3/32" = 1'-0"

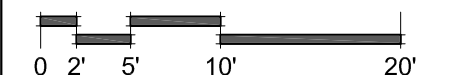

1 Peters Canyon Road, Suite 130
Irvine, CA 92606
Tel: 949-367-8500 Fax: 949-367-0800

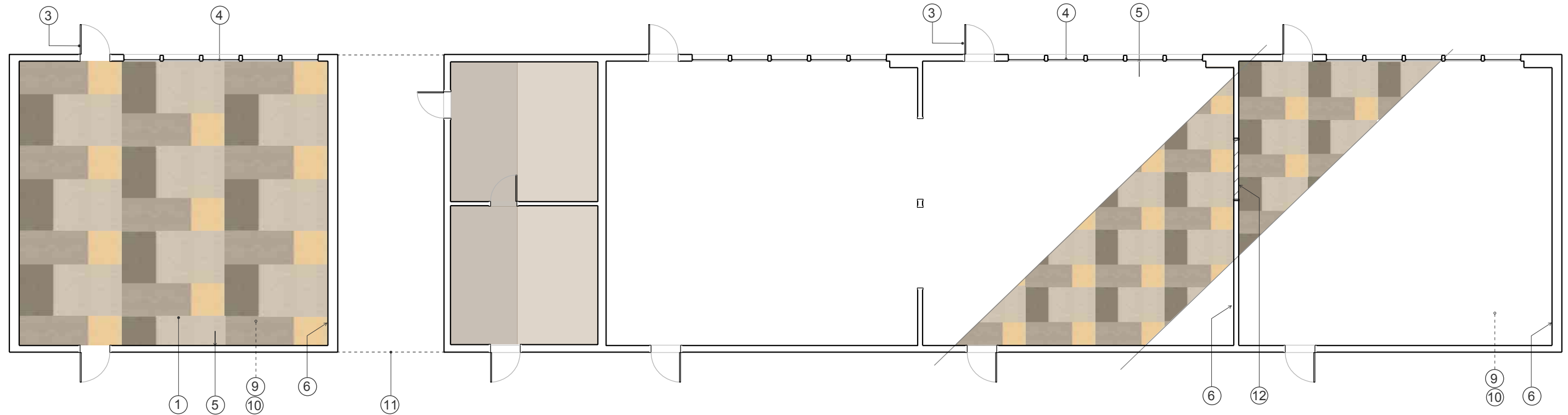

BUILDING 500
(room 505)

BUILDING 500
(rooms 501 - 504)

LEGEND

- | | | |
|---|--------------------------------|-----------------------------|
| ① new vinyl composite tile flooring (VCT) | ⑥ new primary paint color, P2 | ⑪ new opaque fencing / gate |
| ② new epoxy floor coating w/ coved base | ⑦ new accent paint color, A1 | ⑫ new wall / infill |
| ③ new panic device* | ⑧ new accent paint color, A2 | |
| ④ new storefront window system | ⑨ new suspended ceiling system | |
| ⑤ new primary paint color, P1 | ⑩ new 2x4 LED light fixture | |

*as required by code

NOTES

- existing acoustic ceiling tiles to be removed
- existing surface mounted lights to be removed
- all interior walls to be prepared and painted
- all interior walls to be painted 'P1' U.N.O.
- existing window area to be reduced

RIALTO COMMUNITY CENTER

logo:



client: CITY OF RIALTO
335 W Rialto Avenue
Rialto, CA 92376

project address: 214 N Palm Avenue
Rialto, CA 92376

date: 2017.11.01

project no: 17X082.00

scale: 3/32" = 1'-0"

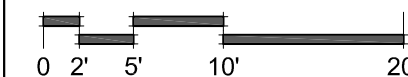

representational floor plan



IDS
IDS GROUP

1 Peters Canyon Road, Suite 130
Irvine, CA 92606
Tel: 949-367-8500 Fax: 949-367-0800

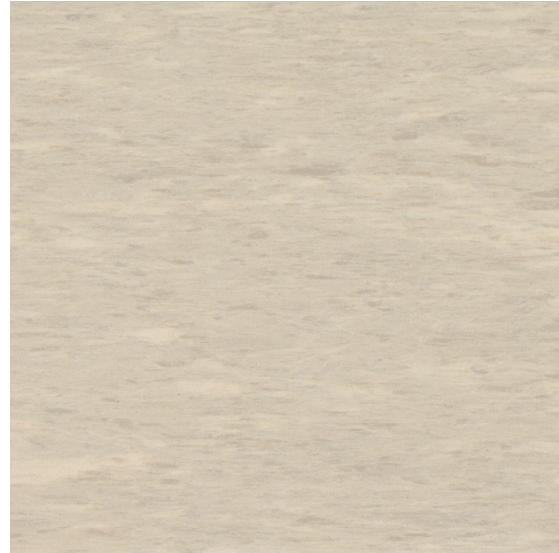

Armstrong Commercial Flooring

VCT

RAFFIA Series

'Pearl' 55803

12 x 24



Armstrong Commercial Flooring

VCT

RAFFIA Series

'Smoke' 55804

12 x 24



Armstrong Commercial Flooring

VCT

RAFFIA Series

'Cocoa' 55805

12 x 24



Armstrong Commercial Flooring

VCT

RAFFIA Series

'Butter' 55806

12 x 24

RIALTO COMMUNITY CENTER

logo:



client: CITY OF RIALTO
335 W Rialto Avenue
Rialto, CA 92376

project address: 214 N Palm Avenue
Rialto, CA 92376

date: 2017.11.01

project no: 17X082.00

scale: 3/32" = 1'-0"

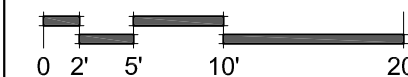

referential images - flooring



IDS GROUP

1 Peters Canyon Road, Suite 130
Irvine, CA 92606
Tel: 949-367-8500 Fax: 949-367-0800

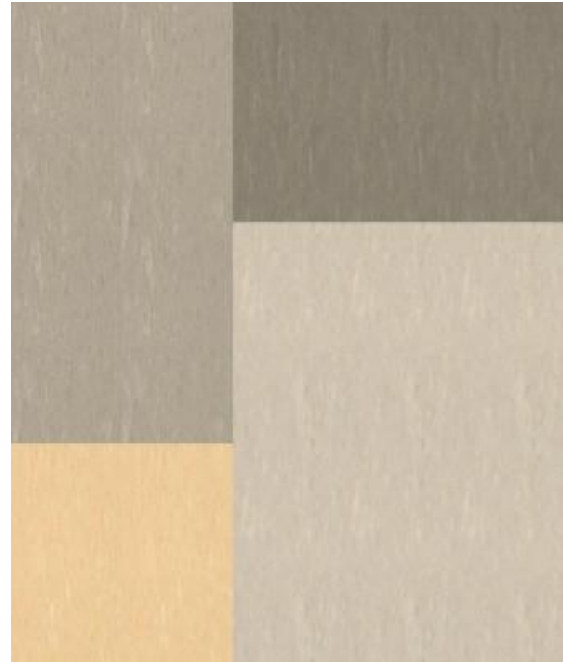

Armstrong Commercial Flooring

VCT

RAFFIA Series

'Building Blocks' pattern 1

12 x 24

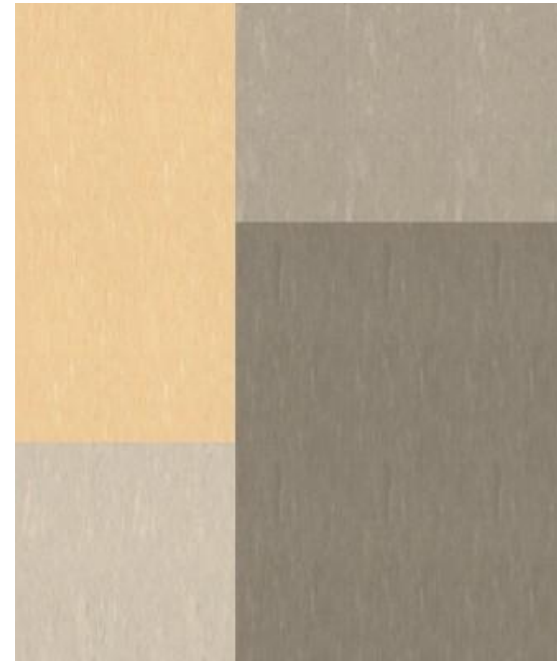

Armstrong Commercial Flooring

VCT

RAFFIA Series

'Building Blocks' pattern 2

12 x 24

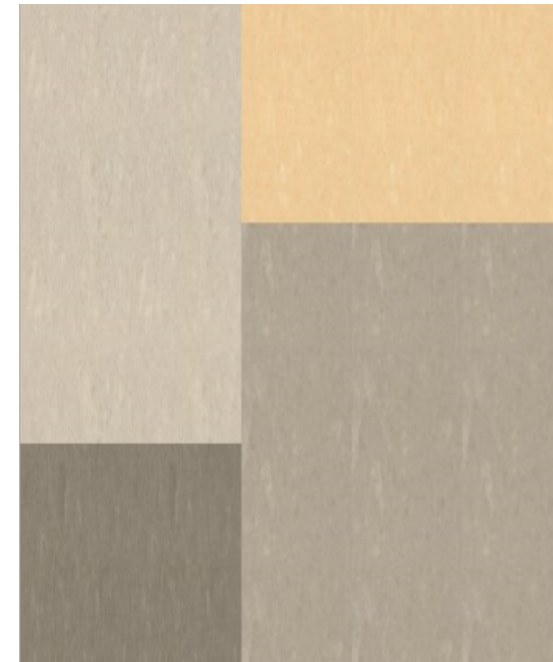

Armstrong Commercial Flooring

VCT

RAFFIA Series

'Building Blocks' pattern 3

12 x 24

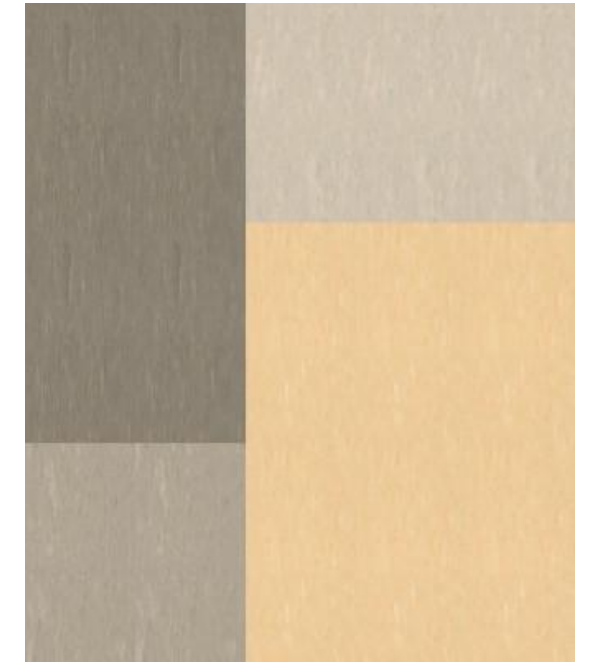

Armstrong Commercial Flooring

VCT

RAFFIA Series

'Building Blocks' pattern 4

12 x 24

RIALTO COMMUNITY CENTER

logo:



client: CITY OF RIALTO
335 W Rialto Avenue
Rialto, CA 92376

project address: 214 N Palm Avenue
Rialto, CA 92376

date: 2017.11.01

project no: 17X082.00

scale: 3/32" = 1'-0"

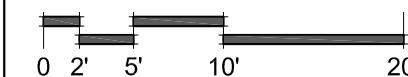

referential images - flooring



IDS GROUP
1 Peters Canyon Road, Suite 130
Irvine, CA, 92606
Tel: 949-367-8500 Fax: 949-367-0800



Johnsonite
Vinyl Wall Base
4" height



Johnsonite
Vinyl Wall Base
typical corner



Johnsonite
Vinyl Wall Base
typical profiles



Johnsonite
Vinyl Wall Base
'Silver Grey' 05
4" height



Johnsonite
Vinyl Wall Base
'Pebble' 32
4" height



Johnsonite
Vinyl Wall Base
'Grey' 48
4" height



Johnsonite
Vinyl Wall Base
'Flaxen' 19
4" height

RIALTO COMMUNITY CENTER

referential images - wall base

logo:



client: CITY OF RIALTO
335 W Rialto Avenue
Rialto, CA 92376

project address: 214 N Palm Avenue
Rialto, CA 92376

date: 2017.11.01

project no: 17X082.00

scale: 3/32" = 1'-0"

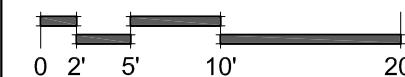

IDS GROUP
1 Peters Canyon Road, Suite 130
Irvine, CA 92606
Tel: 949-367-8500 Fax: 949-367-0800



Dunn Edwards

Primary color 1 (P1)

'Crisp Muslin' DE6212

eggshell finish

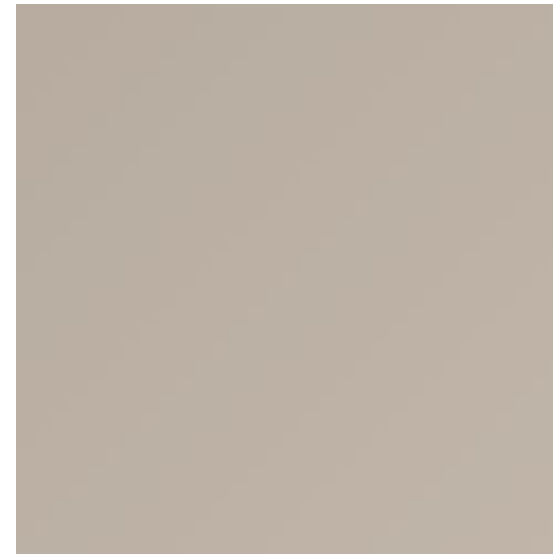

Dunn Edwards

Primary color 2 (P2)

'Ash Gray' DEC751

eggshell finish



Dunn Edwards

Accent color 1 (A1)

'Ancient Earth' DE6217

eggshell finish



Dunn Edwards

Accent color 2 (A2)

'Marble Dust' DE6156

eggshell finish

RIALTO COMMUNITY CENTER

logo:



client: CITY OF RIALTO
335 W Rialto Avenue
Rialto, CA 92376

project address: 214 N Palm Avenue
Rialto, CA 92376

date: 2017.11.01

project no: 17X082.00

scale: 3/32" = 1'-0"

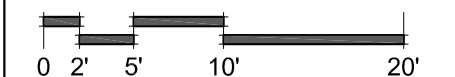

referential images - paint



1 Peters Canyon Road, Suite 130
Irvine, CA, 92606
Tel: 949-367-8500 Fax: 949-367-0800



Armstrong suspended drywall system with Prudential 'Wave' light fixtures

RIALTO COMMUNITY CENTER

referential images - flooring

logo:



client: CITY OF RIALTO
335 W Rialto Avenue
Rialto, CA 92376

project address: 214 N Palm Avenue
Rialto, CA 92376

date: 2017.11.01

project no: 17X082.00

scale: 3/32" = 1'-0"

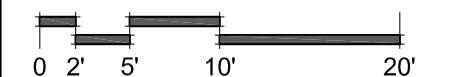

IDS GROUP

1 Peters Canyon Road, Suite 130
Irvine, CA 92606
Tel: 949-387-8500 Fax: 949-387-0800

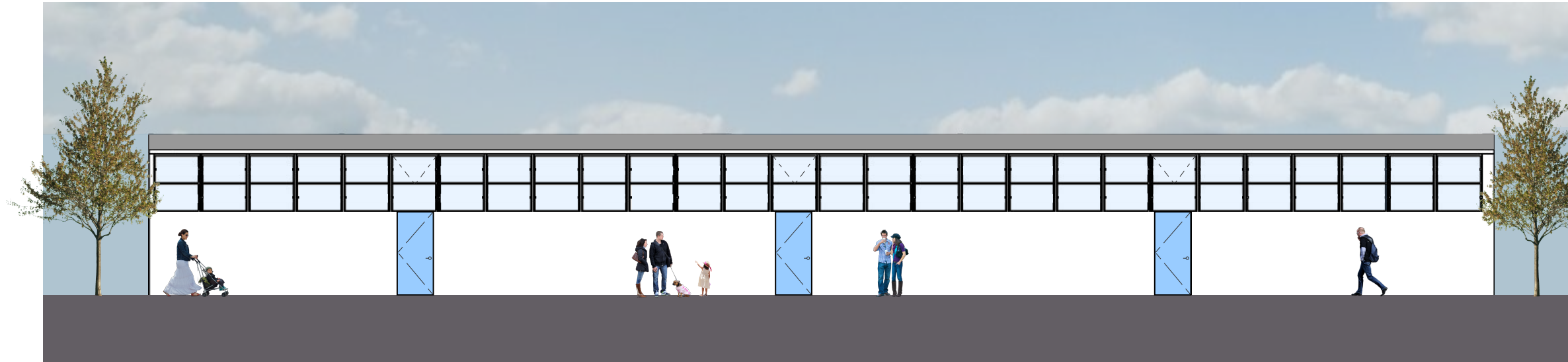

proposed window system

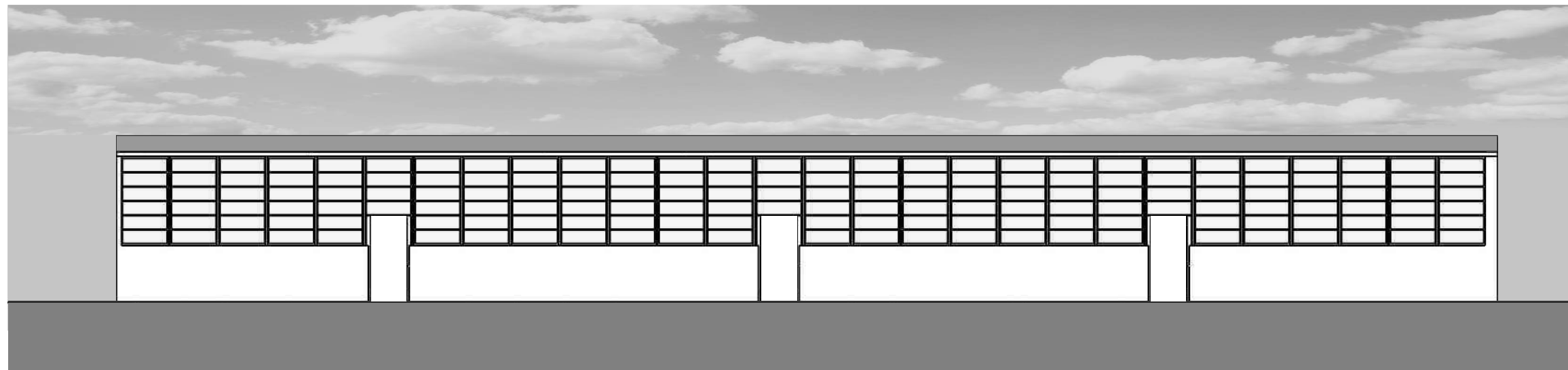

existing window system

Building 200, proposed window system

RIALTO COMMUNITY CENTER

referential images - storefront

logo:



client: CITY OF RIALTO
335 W Rialto Avenue
Rialto, CA 92376

project address: 214 N Palm Avenue
Rialto, CA 92376

date: 2017.11.01

project no: 17X082.00

scale: 3/32" = 1'-0"

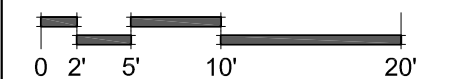

IDS GROUP

1 Peters Canyon Road, Suite 130
Irvine, CA, 92606
Tel: 949-387-8500 Fax: 949-387-0800

CRL / US Aluminum

Storefront

CRL series FT601, (thermally isolated) 6" profile
center glazed w/ **bronze** anodized aluminum finish

Punched openings

CRL series FT451, (thermally isolated) 4.5" profile
center glazed w/ **bronze** anodized aluminum finish

Storefront Doors

CRL series 400 with medium stiles & series 2030 concealed
center glazed w/ **bronze** anodized aluminum finish

Guardian Glass

Glazing

SNX 51/23 or 62/27 series*

clear glazing w/ low-e coating

*to be reviewed & confirmed for T-24 conformance

3M

Architectural Film

FASARA series

'Milano'



3M, Milano

Guardian Glass, SNX 51/23

Transmission

Visible Light %: 51
UV %: 11
Solar Energy %: 19

Add IS20 to Surface #4

Reflectivity

Visible Light Out %: 14
Visible Light In %: 14
Solar Energy %: 36

Heat Gain

Relative Heat Gain: 57
Shading Coefficient: 0.27
Solar Heat Gain Coefficient: 0.23
Light-to-Solar Gain: 2.19

U-Value

Winter Nighttime Argon: 0.24
Winter Nighttime Air: 0.29
Summer Daytime Air: 0.27

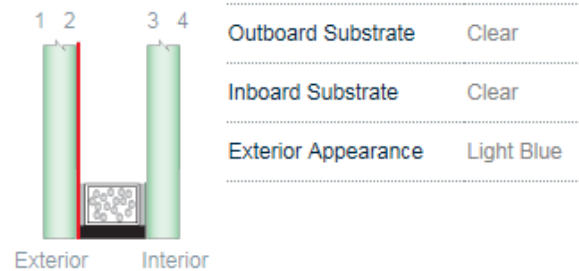

Guardian Glass, SNX 51/23

RIALTO COMMUNITY CENTER

logo:



client: CITY OF RIALTO
335 W Rialto Avenue
Rialto, CA 92376

project address: 214 N Palm Avenue
Rialto, CA 92376

date: 2017.11.01

project no: 17X082.00

scale: 3/32" = 1'-0"

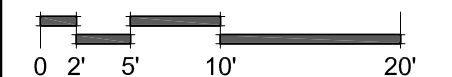

referential images - storefront



IDS GROUP

1 Peters Canyon Road, Suite 130
Irvine, CA 92606
Tel: 949-387-8500 Fax: 949-387-0800



center glazed storefront w/ horizontal mullions
(shown in clear anodized finish)

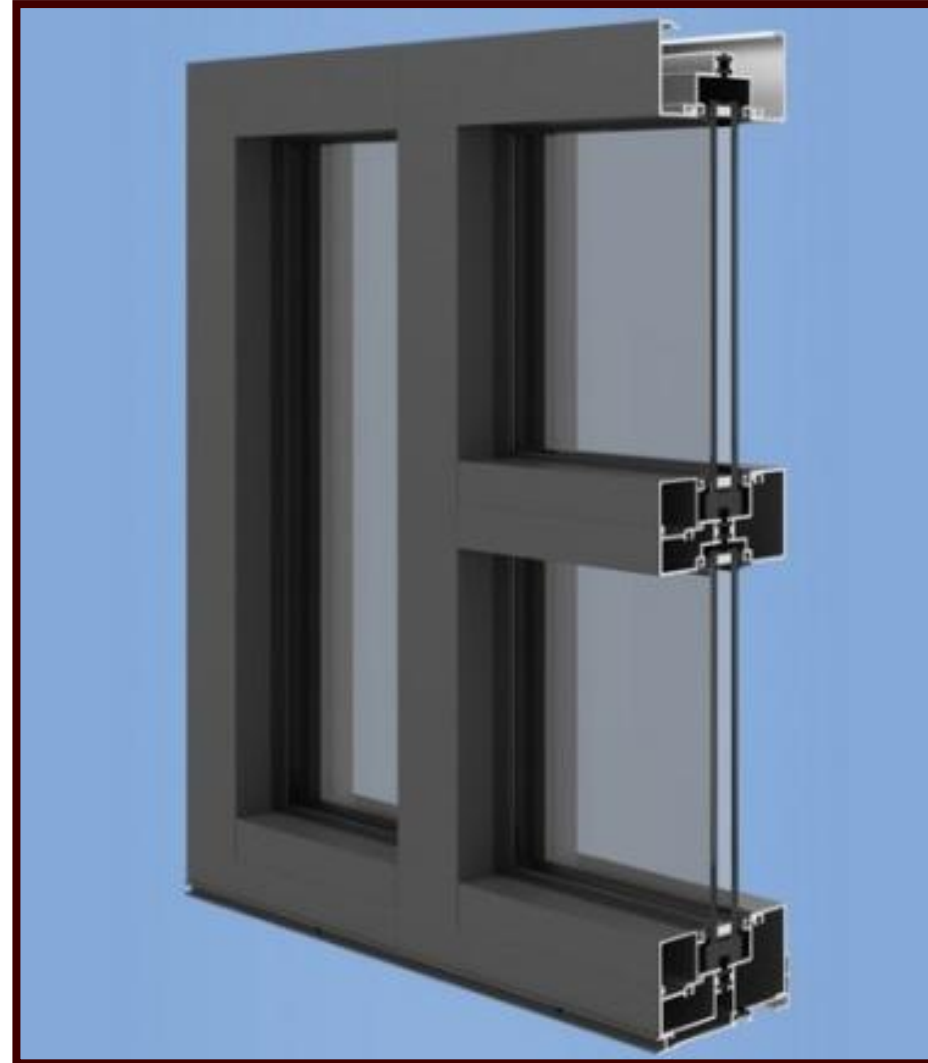

center glazed storefront w/ **bronze** anodized aluminum finish



CRL series FT451 storefront

RIALTO COMMUNITY CENTER

logo:



client: CITY OF RIALTO
335 W Rialto Avenue
Rialto, CA 92376

project address: 214 N Palm Avenue
Rialto, CA 92376

date: 2017.11.01

project no: 17X082.00

scale: 3/32" = 1'-0"

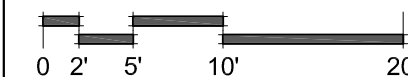

referential images - storefront



IDS GROUP
1 Peters Canyon Road, Suite 130
Irvine, CA 92606
Tel: 949-387-8500 Fax: 949-387-0800



Armstrong Ceiling Solutions

'Fine Fissured' ceiling tile

white

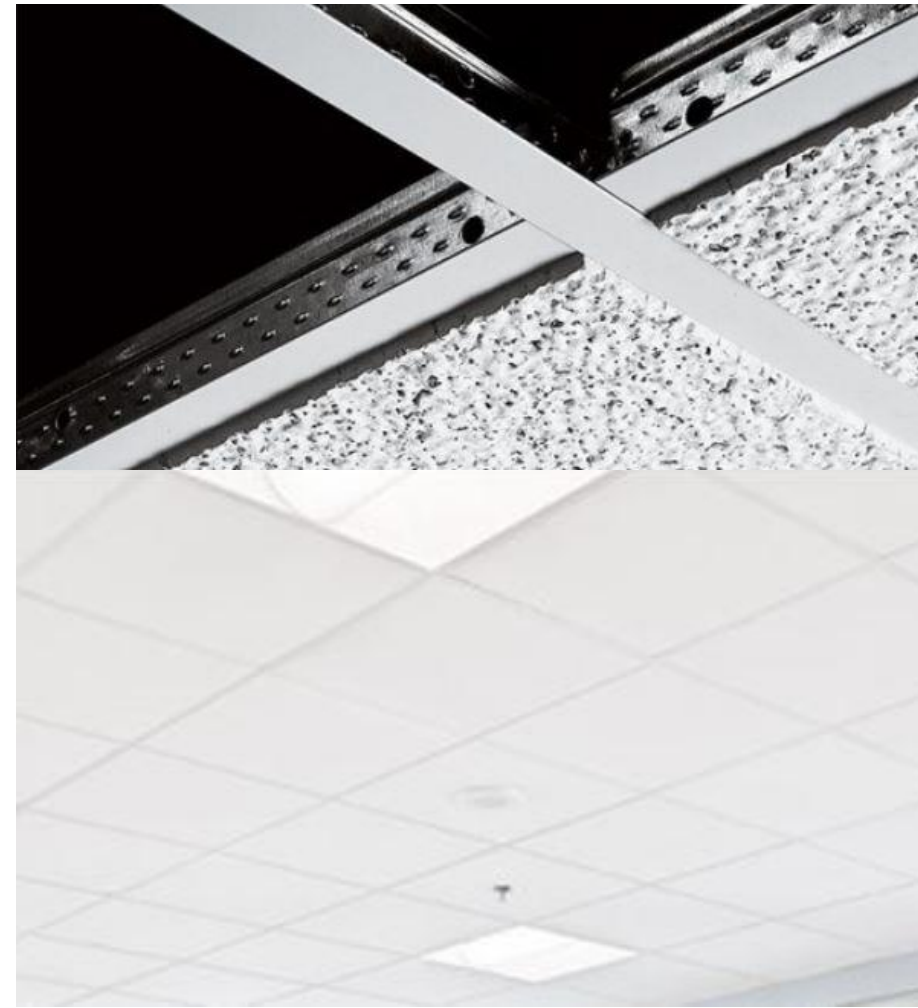

Armstrong Ceiling Solutions

Prelude 15/16" suspension system

white

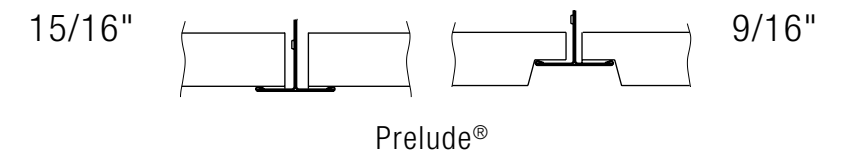

15/16"
Square
Lay-in

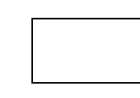

15/16"
Angled
Tegular

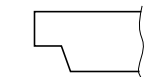

RIALTO COMMUNITY CENTER

logo:



client: CITY OF RIALTO
335 W Rialto Avenue
Rialto, CA 92376

project address: 214 N Palm Avenue
Rialto, CA 92376

date: 2017.11.01

project no: 17X082.00

scale: 3/32" = 1'-0"

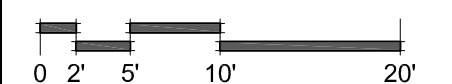

referential images - ceiling



IDS GROUP
1 Peters Canyon Road, Suite 130
Irvine, CA 92606
Tel: 949-387-8500 Fax: 949-387-0800



Armstrong Ceiling Solutions

Axiom canopy system

white

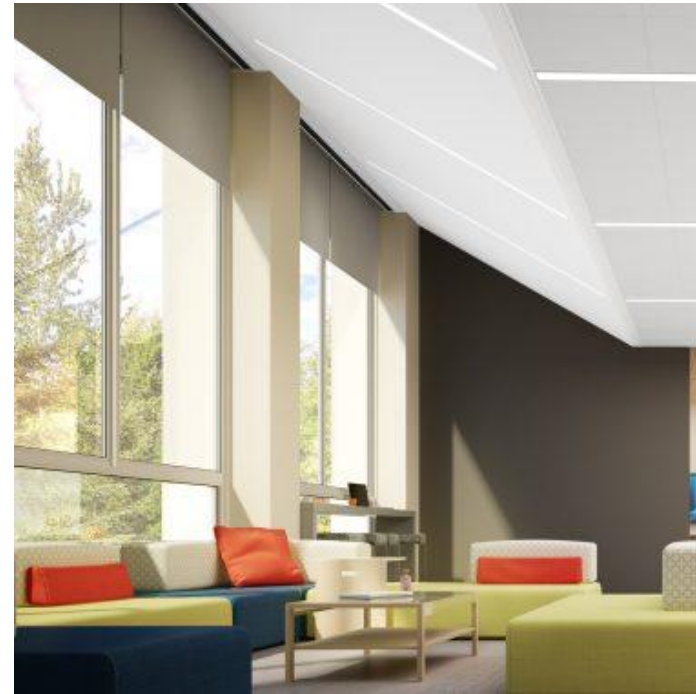

Armstrong Ceiling Solutions

Drywall suspension system

white

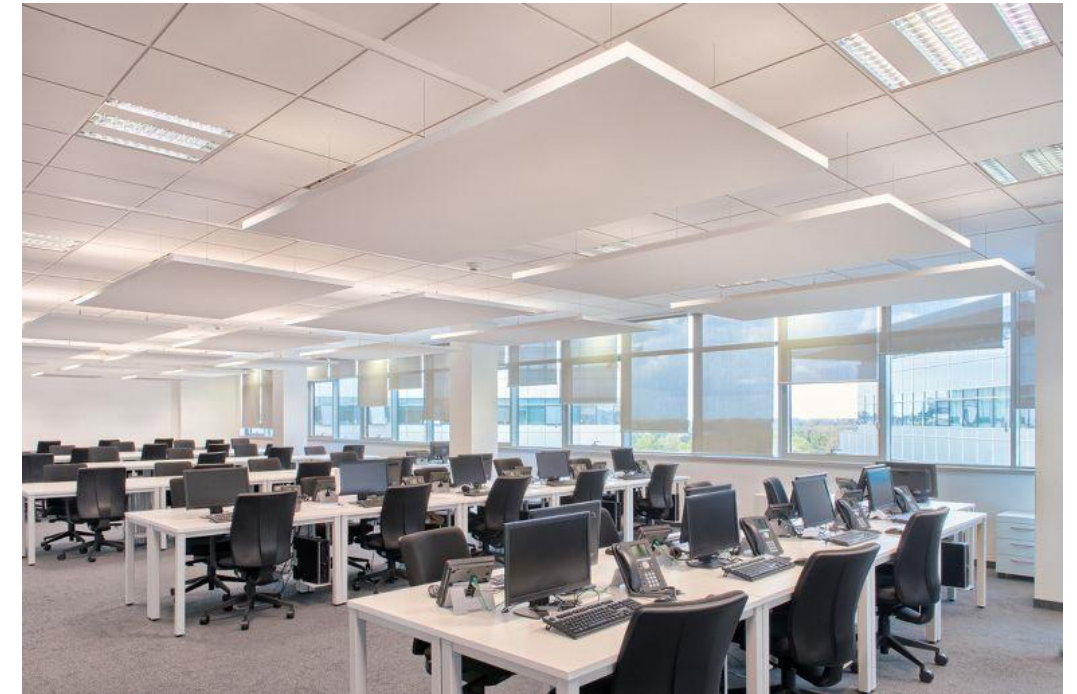

Armstrong Ceiling Solutions

Optima L canopy system

white

RIALTO COMMUNITY CENTER

logo:



client: CITY OF RIALTO
335 W Rialto Avenue
Rialto, CA 92376

project address: 214 N Palm Avenue
Rialto, CA 92376

date: 2017.11.01

project no: 17X082.00

scale: 3/32" = 1'-0"

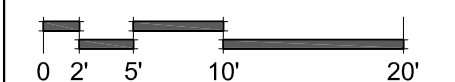

referential images - ceiling



1 Peters Canyon Road, Suite 130
Irvine, CA 92606
Tel: 949-367-8500 Fax: 949-367-0800

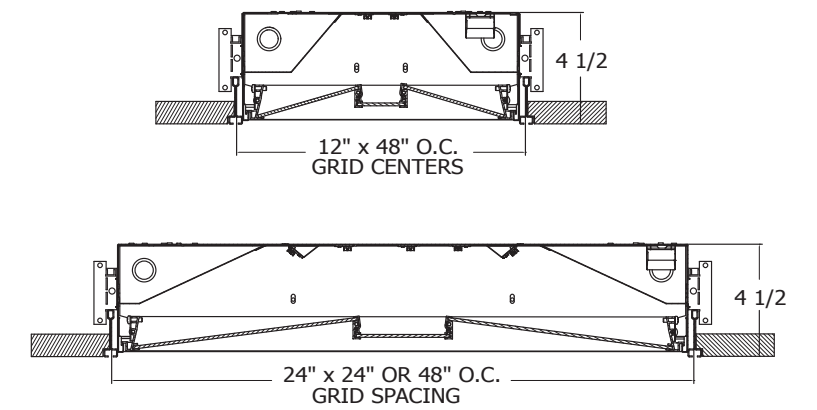

Prudential Lighting

pendant mounted LED fixture

'Wave'

white

Mark Architectural Lighting

recessed mounted LED fixture

'Whisper'

white

RIALTO COMMUNITY CENTER

logo:



client: CITY OF RIALTO
335 W Rialto Avenue
Rialto, CA 92376

project address: 214 N Palm Avenue
Rialto, CA 92376

date: 2017.11.01

project no: 17X082.00

scale: 3/32" = 1'-0"

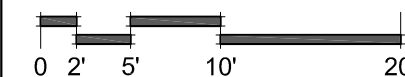

referential images - lighting



IDS GROUP

1 Peters Canyon Road, Suite 130
Irvine, CA 92606
Tel: 949-367-8500 Fax: 949-367-0800



Ametco Manufacturing Company

Aluminum - Eclipse 100 design

louvered panel



Ametco Manufacturing Company

Aluminum - Polaris design

perforated panel



Ametco Manufacturing Company

Aluminum - Venetian design

louvered panel

RIALTO COMMUNITY CENTER

logo:



client: CITY OF RIALTO
335 W Rialto Avenue
Rialto, CA 92376

project address: 214 N Palm Avenue
Rialto, CA 92376

date: 2017.11.01

project no: 17X082.00

scale: 3/32" = 1'-0"

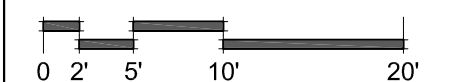

referential images - fencing



IDS GROUP
1 Peters Canyon Road, Suite 130
Irvine, CA 92606
Tel: 949-387-8500 Fax: 949-387-0800