



**BLOOMINGTON, CASA
GRANDE, AND MAPLE
IMPROVEMENTS
25082**

PROJECT SCOPE

1. **CASA GRANDE GRIND AND CAP**
2. **BLOOMINGTON INTERSECTION AND ACCESSIBILITY IMPROVEMENTS**
3. **SOUTH MAPLE IMPROVEMENTS**

CASA GRANDE GRIND AND CAP



Grind & Cap Casa Grande from Alder Avenue to Mango Avenue

CASA GRANDE GRIND AND CAP



Match Fontana's striping west of Mango Avenue and remove temporary barricades to open access for residents to travel to and from Sierra Avenue.

BLOOMINGTON INTERSECTION AND IMPROVEMENTS



BLOOMINGTON INTERSECTION AND IMPROVEMENTS

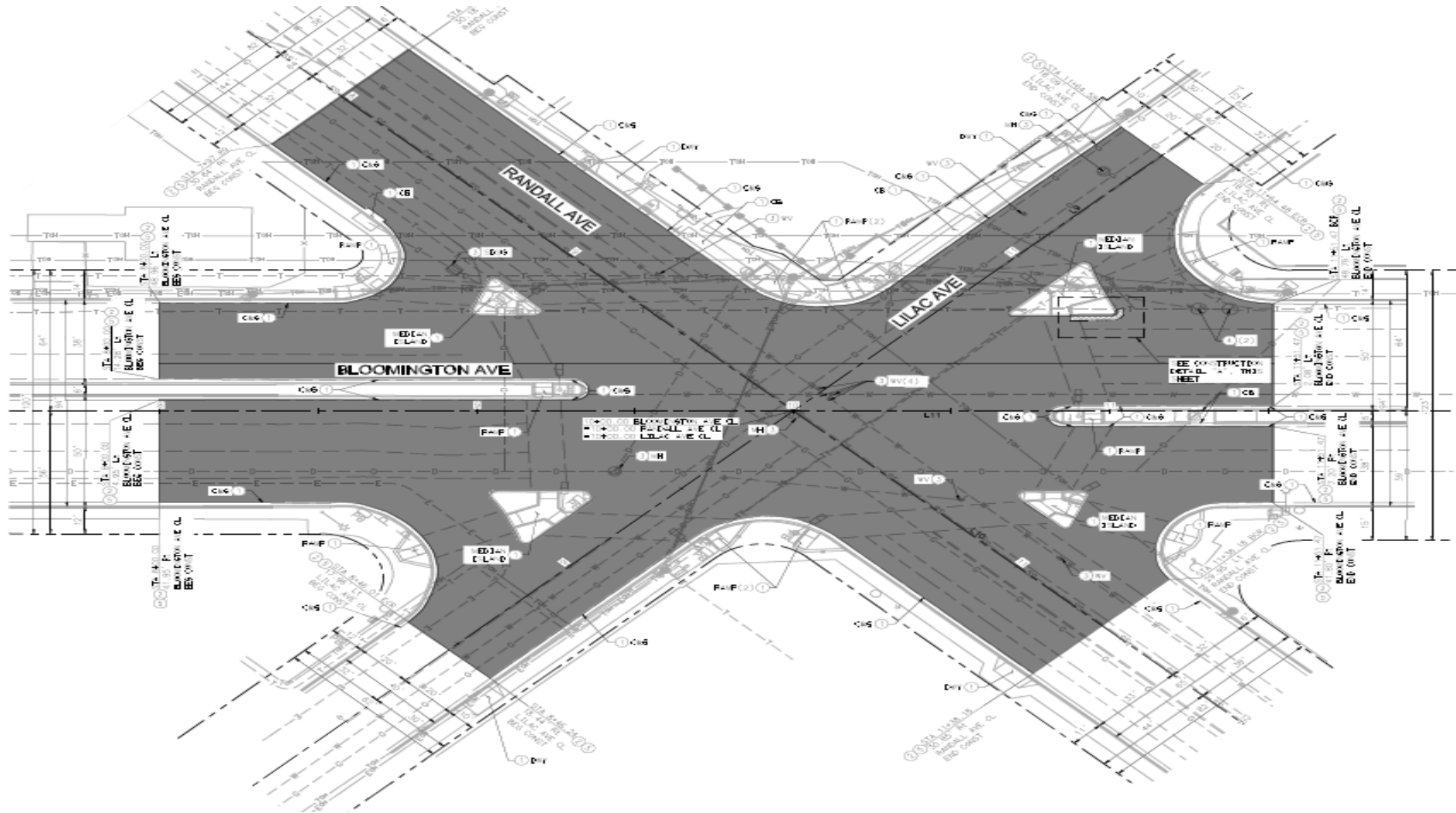

BLOOMINGTON INTERSECTION AND IMPROVEMENTS

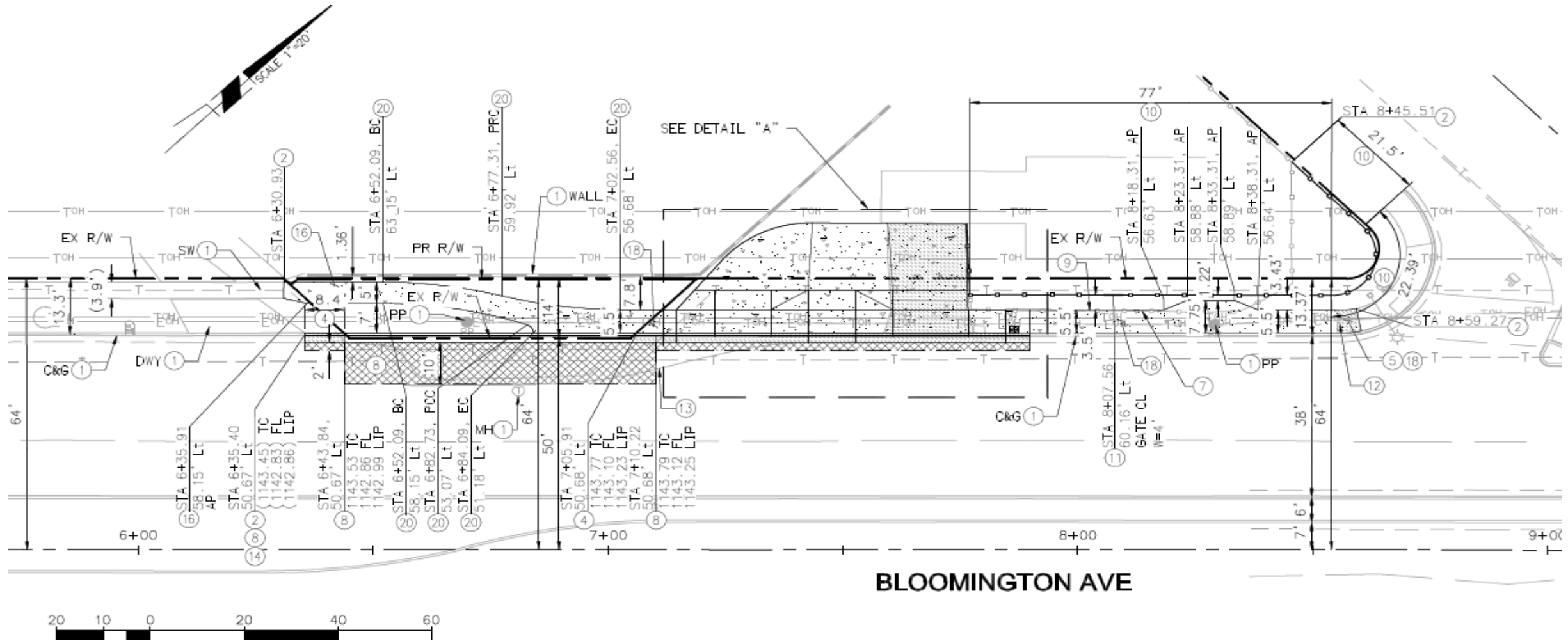

SOUTH MAPLE IMPROVEMENTS



SOUTH MAPLE IMPROVEMENTS

