

### GENERAL LANDSCAPING NOTES

PER CITY OF RIALTO MUNICIPAL CODE SECTION 18.58 030-(K)

- A MINIMUM OF TEN PERCENT OF THE REQUIRED GROSS OFF-STREET PARKING AREA SHALL BE LANDSCAPED. THE PARKING AREA SHALL INCLUDE ACCESS DRIVES, AISLES, STALLS, MANEUVERING AREAS AND REQUIRED LANDSCAPE SETBACKS AROUND THE PERIMETER OF THE PARKING FACILITY.
- WHERE REQUIRED BY THE DEVELOPMENT REVIEW COMMITTEE, LANDSCAPED AREAS SHALL BE ANNEXED INTO THE CITY OF RIALTO LANDSCAPE MAINTENANCE DISTRICT NO. 1, AS PROVIDED BY DIVISION 15 OF THE STATE STREETS AND HIGHWAYS CODE AND CITY POLICY.
- LANDSCAPE MATERIALS SHALL INCLUDE PLANTS ACCEPTABLE TO THE DIRECTOR OF DEVELOPMENT SERVICES AND SHALL EMPHASIZE THE USE OF DROUGHT-RESISTANT GROUND COVERS, SHRUBS AND TREES TO THE EXTENT FEASIBLE. AT LEAST ONE FIFTEEN GALLON TREE SHALL BE INSTALLED AND MAINTAINED FOR EVERY FIVE PARKING STALLS IN THE PARKING FACILITY. SUCH TREES MAY BE CLUSTERED OR GROUPED IF APPROVED BY THE DIRECTOR OF DEVELOPMENT SERVICES.
- AN IRRIGATION SYSTEM IN AGREEMENT WITH AN IRRIGATION PLAN ACCEPTABLE TO THE DIRECTOR OF DEVELOPMENT SERVICES SHALL BE INSTALLED AND MAINTAINED IN WORKING ORDER.
- LANDSCAPING SHALL BE CONTINUOUSLY MAINTAINED AND REPLANTED AS NECESSARY. LANDSCAPED AREAS SHALL BE KEPT FREE OF DEBRIS AND LITTER.
- LANDSCAPED AREAS SHALL BE SEPARATED FROM VEHICLE PARKING AND CIRCULATION AREAS BY CONCRETE CURBS NOT LESS THAN SIX INCHES IN HEIGHT.

### PRELIMINARY PLANT PALETTE

BOTANICAL NAME	COMMON NAME
TREES (15 GAL. MIN)	
GLEDITSIA TRIACANTHOS	HONEY LOCUST
CERCIS CANADENSIS	EASTERN REDBUD
PISTACIA CHINENSIS	CHINESE PISTACHE
SHRUBS/PERENNIALS	
MULLENBERGIA RIGENS	DEER GRASS
SIMMONDSIA CHINENSIS	WOOLLY JERUSALEM SAGE
PHLOMIS LANATA	OCOTILLO
FOUQUIERA SPLENDENS	SANTOLINA
SANTOLINA PINNATA	SALVIA DIVINORUM
SALVIA DIVINORUM	SANTOLINA CHAEMACYPARISSUS
SANTOLINA CHAEMACYPARISSUS	RED YUCCA
HERPESALOE PARVIFLORA	AUTUMN SAGE
SALVIA GREGGII	PAMPAS GRASS
CORTADERIA SELLOANA	
GROUND COVERS	
BACCHARIS PILLULARIS	DWARF COYOTE BUSH
ROSEMARY PROSTRATUS	ROSEMARY
HELICOTRICHON SEMPERVIRENS	BLUE OAT GRASS

PRELIMINARY LANDSCAPING PLAN

1" = 10'-0" 2

PARKING AREA - LANDSCAPE CALCULATION:	
PER 18.58 030-(K)	
GROSS PARKING AREA:	48,623 S.F. (includes access drives, aisles, stalls, maneuvering areas)
LANDSCAPING REQUIRED (10% OF PARKING AREA):	4,862 S.F. x 0.10 = 4,863 S.F. REQUIRED
LANDSCAPING PROVIDED AT PARKING AREA:	5,182 S.F. PROVIDED (10.6%) ✓ COMPLIES

BUILDING AREA - LANDSCAPE CALCULATION:	
PER 18.58 030-(K)	
HARDSCAPE AREA:	12,234 S.F. (includes all on-curb/sidewalk areas)
LANDSCAPING REQUIRED (10% OF HARDSCAPE AREA):	1,223 S.F. x 0.10 = 122.3 S.F. REQ'D
LANDSCAPING PROVIDED (ON-CURB AROUND BUILDING):	1,249 S.F. PROVIDED (10.2%) ✓ COMPLIES

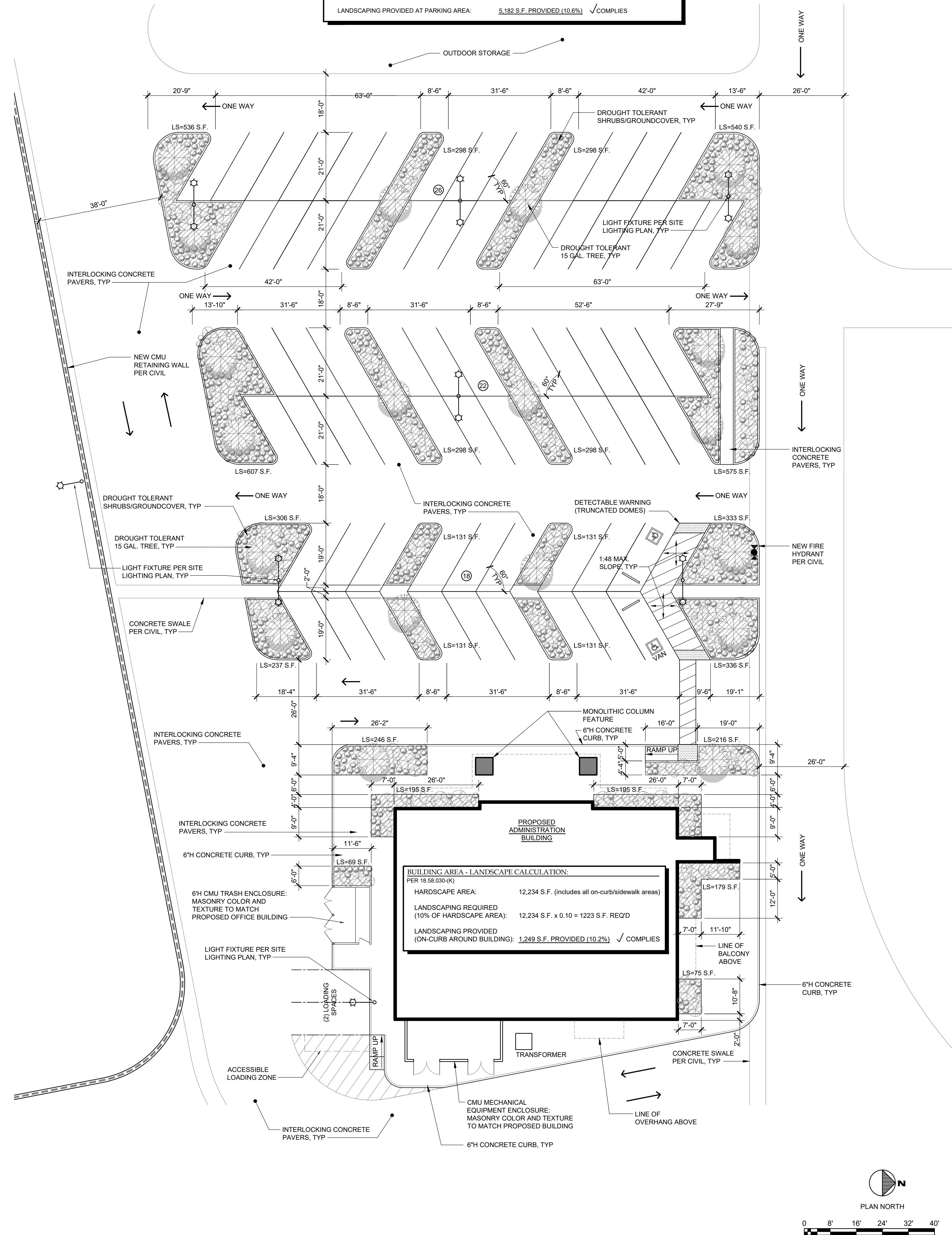
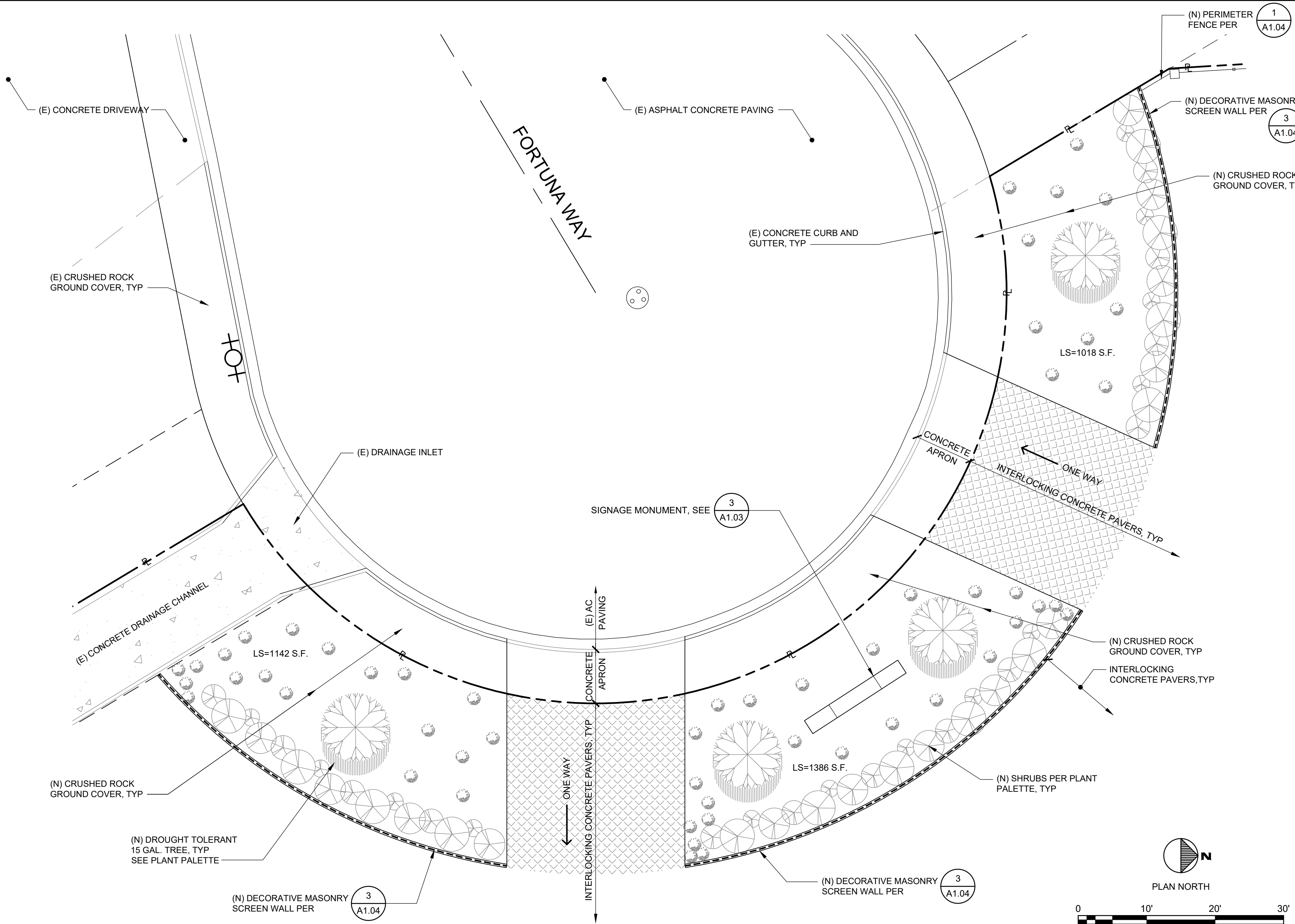

PRELIMINARY LANDSCAPING PLAN

1/16" = 1'-0" 1

Any and all reproduction of this document is prohibited, including but not limited to, making copies of any kind, or scanning or digitizing the document into electronic media of any kind, without the prior, express and written consent of LONI, INC. The client of this document is that all applicable codes and ordinances shall be fully complied with, and that all labor and material be provided to make the work represented hereon complete and operational in every respect. Drawings are dimensioned in feet and inches, and shall not be modified in any manner or by any means except by its owner, LONI, INC. Use of this document, in whole or in part, is limited to one time, for the specific purpose of implementing the work represented hereon and for no other use of this document shall be made without the prior, express and written consent of LONI, INC.

Sheet
Drawn By
Permit No.
Date

L1.01
F. LONI
19-050
02/11/2021

Job Number
19-050

Revisions
Mark
Date

Revisions
Mark
Date

Revisions
Mark
Date

Revisions
Mark
Date

LONI, INC.  
architect + engineering  
1050 Lakes Dr #231 West Covina, CA 91790  
T: 626.908.9977  
E: sam@loniarchitects.com  
www.loniarchitects.com

FRANK J. LONI  
C-35616  
REL. 7/31/2021

FRANK J. LONI  
A-106161  
REL. 12/31/2020

ANGELUS BLOCK CO., INC.  
PROCESSED AND APPROVED BY THE CITY  
APNS: 026-04-01-67-0000, 026-04-61-41-0000, 026-04-61-42-0000  
RIALTO, CA 92316