

Confirmed copy

SHEET 1 OF 1

ANNEXATION MAP NO. 8 OF
COMMUNITY FACILITIES DISTRICT NO. 2016-1
(PUBLIC SERVICES)
CITY OF RIALTO
SAN BERNARDINO COUNTY
STATE OF CALIFORNIA

LEGEND

■ ■ ■ ■ Proposed Boundaries of City of
Rialto Annexation Map No. 8 of
Community Facilities District No.
2016-1 (Public Services)
— Assessor Parcel Line

Reference is made to that boundary map of the
Community Facilities District No. 2016-1 (Public
Services) of the City of Rialto recorded with the
San Bernardino County Recorder's office on
October 6, 2016 in book 87, page 29 of Maps of
Assessment and Community Facilities Districts,
as instrument no. 2016-0418016.

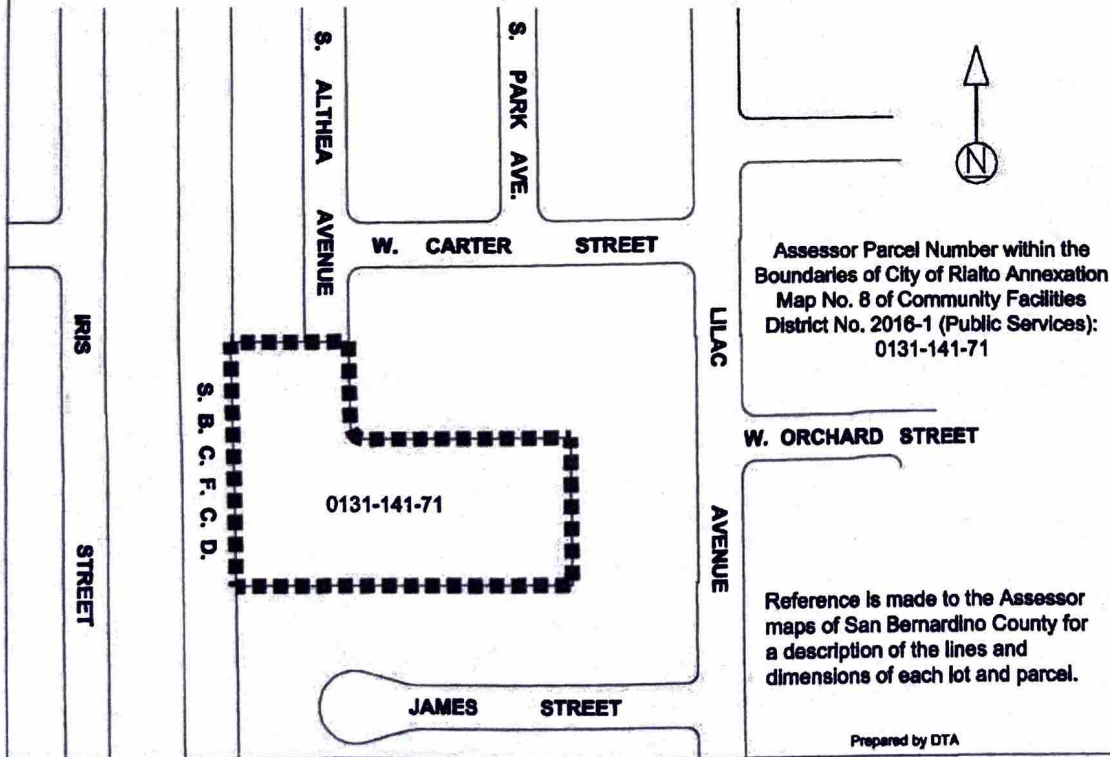

(1) Filed in the office of the Clerk of the City of Rialto this 22nd
day of July, 2025.

Barbara A. McGee
Barbara McGee, Clerk of the City of Rialto,
California

(2) I hereby certify that the within map showing the proposed
boundaries of Annexation Map No. 8 of Community Facilities
District No. 2016-1 (Public Services) of the City of Rialto, San
Bernardino County, State of California, was approved by the
City Council of the City of Rialto at a regular meeting thereof,
held on the 22nd day of July, 2025, by its
Resolution No. 8372.

Barbara A. McGee
Barbara McGee, Clerk of the City of Rialto,
California

San Bernardino County Recorder's Certificate

This map has been filed under Document Number
2025-0185479, this 5th day of August, 2025,
at 1:29 p.m., in Book 92 of Maps of Assessment and
Community Facilities Districts at page 51, in the office of
the county recorder in San Bernardino County, State of California,
at the request of the City of Rialto in the amount of
\$ 11.00.

Josie Gonzales
Assessor-Recorder
San Bernardino County

By: Josie Gonzales
Deputy Recorder

Prepared by DTA