

Owner:



280 Newport Center Dr. Suite 240  
Newport Beach, CA 92660  
tel: 949-330-7564

Project:

**Orbis Rialto  
Renaissance Pkwy  
& Locust**

Consultants:

Civil: Kimley Horn  
Structural:  
Mechanical:  
Plumbing:  
Electrical:  
Landscape:  
Fire Protection:  
Soils Engineer:

Title: OVERALL FLOOR PLAN

Project Number: 18186  
Drawn by: SLM  
Date: 1/12/2021  
Revision:

Sheet:

**DAB-A2.1**

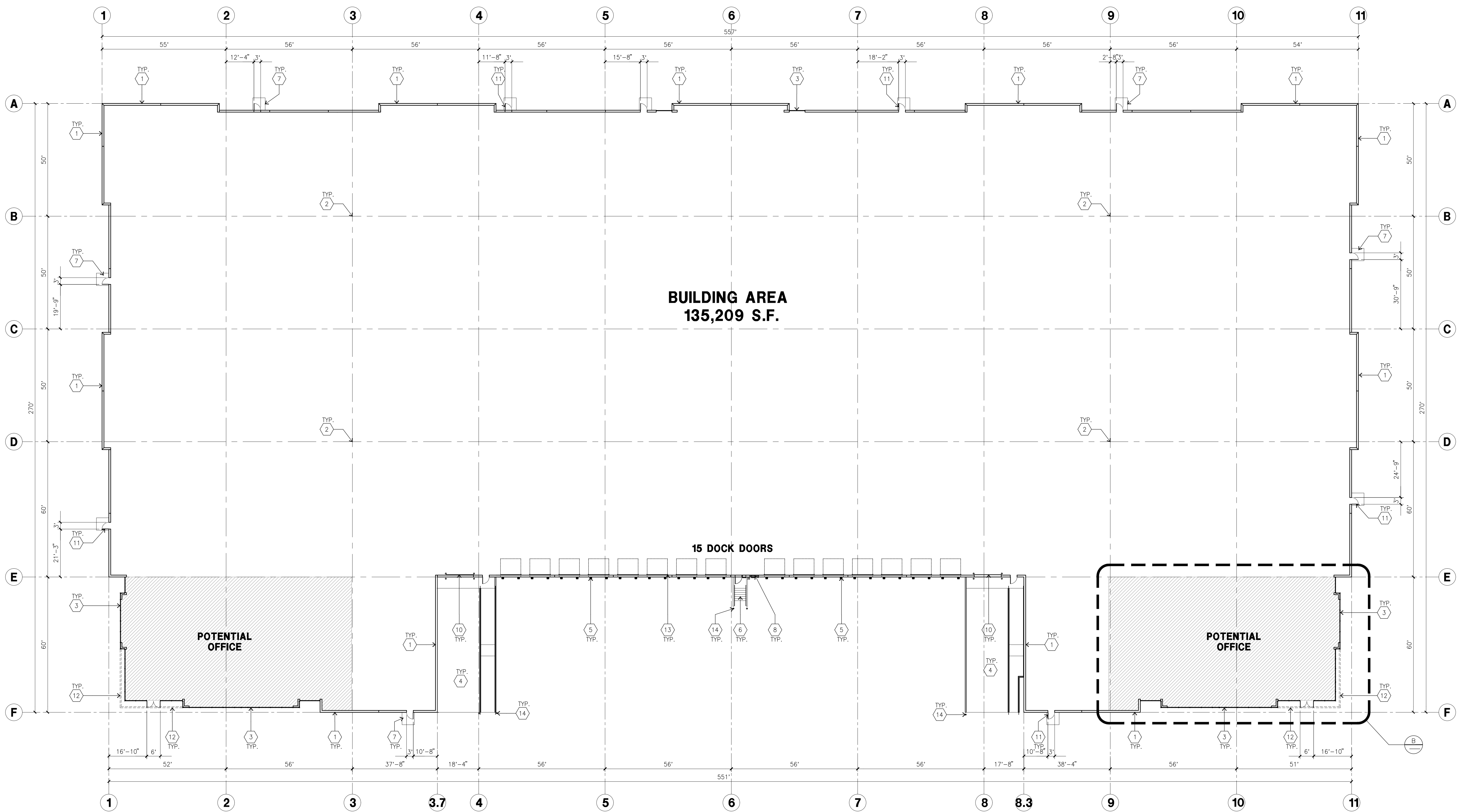

**BUILDING AREA  
135,209 S.F.**

**15 DOCK DOORS**

**POTENTIAL OFFICE**

**POTENTIAL OFFICE**

**OVERALL FLOOR PLAN**  
scale: 1" = 20'-0"

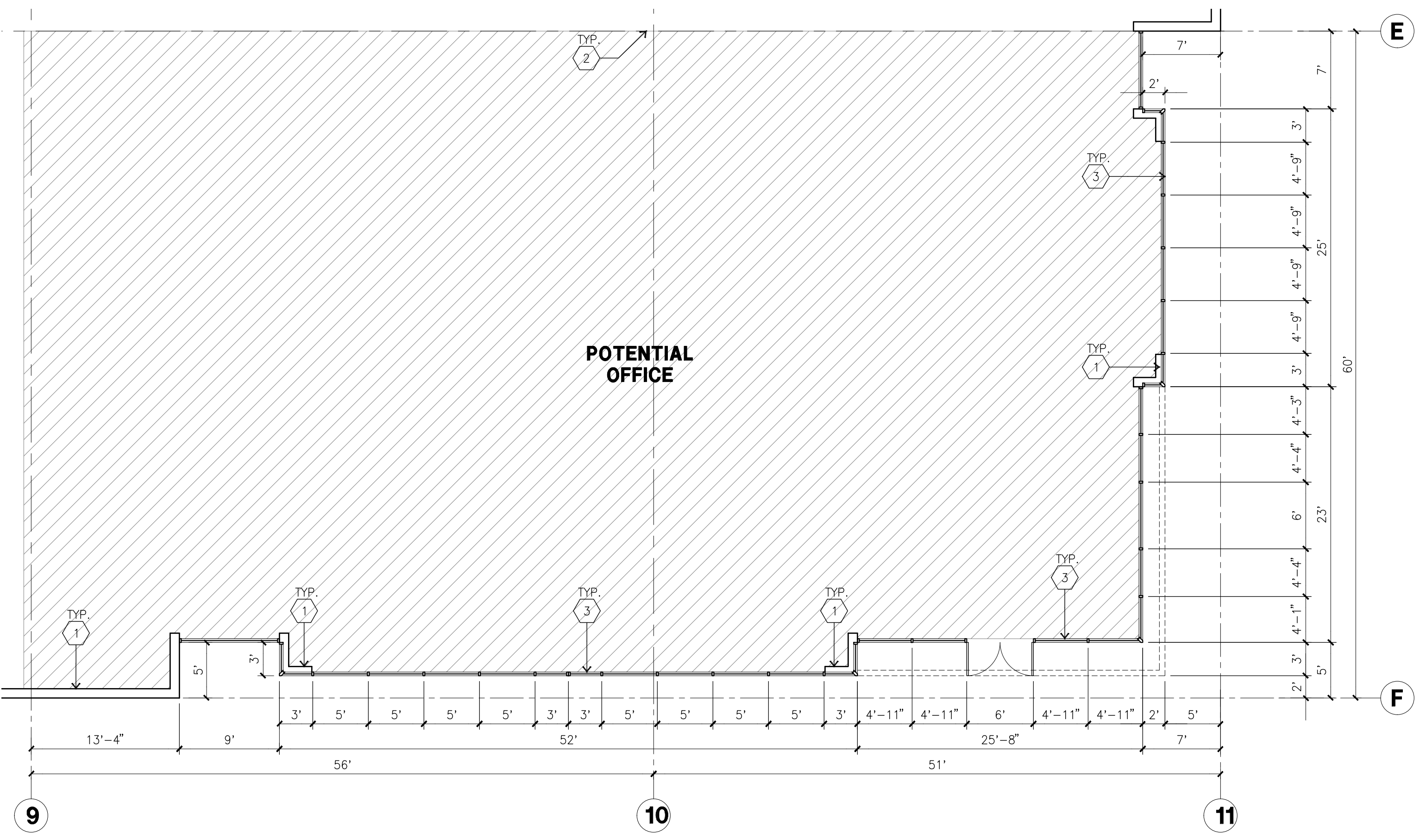
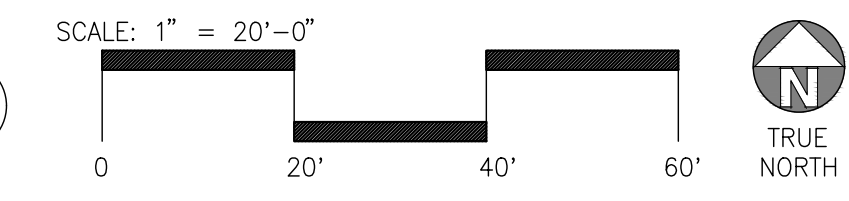

**ENLARGED SITE PLAN**  
scale: 1/8" = 1'-0"

**KEYNOTES - FLOOR PLAN**

- 1 CONCRETE TILT-UP PANEL. FOR THICKNESS AND STEEL REQUIREMENTS.
- 2 STRUCTURAL STEEL COLUMN.
- 3 TYPICAL STOREFRONT SYSTEM WITH GLAZING. SEE OFFICE BLOW-UP AND ELEVATIONS FOR SIZE, COLOR AND LOCATIONS.
- 4 CONCRETE RAMP W/ 42" HIGH CONC TILT-UP GUARD WALL OR BUILDING WALL ON BOTH SIDE OF RAMP.
- 5 9'-0" X 10' TRUCK DOOR, SECTIONAL O.H., STANDARD GRADE.
- 6 EXTERIOR CONCRETE STAIR
- 7 5'-6" X 5'-6" X 4" THICK CONCRETE EXTERIOR LANDING PAD TYPICAL AT ALL EXTERIOR MAN DOORS TO LANDSCAPED AREA. FINISH TO BE MEDIUM BLOOM FINISH. SLOPE TO BE 1/4" - 12" MAX. PROVIDE WALK TO HARD SURFACE PER CITY REQUIREMENTS.
- 8 LOUVERED OPENING FOR VENTILATION.
- 9 ADA ACCESSIBLE SHOWER
- 10 12' X 16' DRIVE THRU, SECTIONAL O.H., STANDARD GRADE. DESIGNED TO RESIST WIND 90 MPH., EXPOSURE "C".
- 11 3'X7' HOLLOW METAL EXTERIOR MAN DOOR.
- 12 COMPOSITE METAL ALUMINUM CANOPY.
- 13 Z GUARD.
- 14 CONC. FILLED GUARD POST. 6" DIA. U.N.O.. 42"H.
- 15 INTERIOR ROOFDRAINS WITH OVERFLOW SCUPPER.

**FLOOR SLAB AND POUR STRIPS REQ.**

- THESE NOTES ARE VERY MIN. REQUIREMENT. SEE "S" DWGS FOR ADDITIONAL REQUIREMENTS
1. FLOOR COMPACTION - 95%
  2. TRENCH COMPACTION - 90%
  3. BUILDING FLOOR SLAB:
    - A. 8" THICK MIN. UNREINFORCED CONCRETE OVER COMPACTED SOILS
    - B. 3/4" - 16" LONG @ 12" O.C. DOWELS AT ALL CONSTRUCTION JOINTS
    - C. 3/4" - 16" LONG @ 24" O.C. DOWELS IN DOWEL BASKET AT ALL CONTROL JOINTS.
    - C. 4,000 P.S.I. REQUIREMENT.
    - D. SLUMP TO BE 4" +/- 1"
    - E. JOINT SPACING PER A.C.I. 302-IR-96
    - F. SAW-CUT DEPTH 1/4 T; SOFT SAW-CUTTING WITHIN 2 HRS OF FINISHING
  4. CONTRACTOR TO BUILD FOR CLASS V FLOOR PER A.C.I. 302-IR-96
  5. NOT USED
  6. CONCRETE SLAB TO HAVE STEEL FLOAT HARD TROWEL BURNISHED FINISH.
  7. CONTRACTOR TO CURE SLAB TO BE WET CURING USING BURLINE FOR 7 DAYS MIN.
  8. ALL EQUIPMENT & MOVING VEHICLES SHALL BE DIAPERED.
  9. NO CRANES, CONCRETE TRUCKS, OR ANYTHING HEAVY WILL BE PLACED ON THE SLAB.
  10. SLAB TO BE FF35 FL24 MEASURED WITHIN 24 HOURS.
  11. NO FLY ASH IN THE CONCRETE
  12. WHERE INDICATED, PROVIDE VAPOR BARRIER (15ML STEGO OR EQUAL) UNDER THE CONCRETE SLAB. PROVIDE SAND PER SOILS ENGINEER OR MANUFACTURER'S RECOMMENDATION. CONCRETE SLAB IN POTENTIAL FUTURE OFFICE AREAS, WHERE SAND OVER WQUEEN ARE REQUIRED, SHALL BE NATURALLY HYDRATED WITHOUT USE OF BURELNE, CURING COMPOUND, OR RELEASE AGENTS. CONTROL/CONSTRUCTION JOINTS SHALL NOT BE FILLED WITH MM-80 JOINT FILLER IN POTENTIAL FUTURE OFFICE AREAS.
  13. SEAL CONCRETE SLAB W/ "LIPIDOLITH" SEALER

**GENERAL NOTES - FLOOR PLAN**

- A. THIS BUILDING IS DESIGNED FOR HIGH PILE STORAGE WITH FIRE ACCESS MAN DOORS AT 100' MAXIMUM O.C. A SEPARATE PERMIT WILL BE REQUIRED FOR ANY RACKING/CONVEYER SYSTEMS.
- B. FIRE HOSE LOCATIONS SHALL BE APPROVED PER FIRE DEPARTMENT.
- C. THE BUILDING FLOOR SLAB IS FLAT, SEE "C" DRAWINGS FOR FINISH SURFACE ELEVATIONS.
- D. NOT USED
- E. WAREHOUSE INTERIOR CONCRETE WALLS ARE PAINTED WHITE. COLUMNS ARE TO RECEIVE SAFETY YELLOW TO 12" AFF AND WHITE TO UNDERSIDE OF DECK. ALL GYB BD WALLS IN WAREHOUSE TO RECEIVE 1 COAT OF WHITE PAINT
- F. SLOPE POUR STRIP 1/2" TO EXTERIOR AT ALL MANDOOR EXITS. SEE "S" DRAWINGS FOR POUR STRIP LOCATION.
- G. ALL DIMENSIONS ARE TO THE FACE OF CONCRETE PANEL WALL, GRIDLINE, OR FACE OF STUD U.N.O.
- H. SEE CIVIL DRAWINGS FOR POINT OF CONNECTIONS TO OFF-SITE UTILITIES. CONTRACTOR TO VERIFY ACTUAL UTILITY LOCATIONS. PLUMBING/ELECTRICAL COORDINATION.
- I. FOR DOOR TYPES AND SIZES, SEE DETAIL SHEET AD.4. NOTE: ALL DOORS PER DOOR SCHEDULE ARE FINISH OPENINGS.
- J. CONTRACTOR TO PROTECT AND KEEP THE FLOOR SLAB CLEAN. ALL EQUIPMENT TO BE DIAPERED INCLUDING CARS AND TRUCKS.
- K. ALL EXIT MAN DOORS IN WAREHOUSE TO HAVE ILLUMINATED EXIT SIGN. HARDWARE.
- L. HIGHLY FLAMMABLE AND COMBUSTIBLE MATERIAL SHALL NOT BE USED OR STORED IN THIS BUILDING.
- M. EACH EXTERIOR EXIT DOOR SHALL BE IDENTIFIED BY A TACTILE EXIT SIGN WITH THE WORDS "EXIT". THE MOUNTING HEIGHT FOR SUCH SIGNAGE SHALL BE 60" FROM FINISH FLOOR LEVEL TO THE CENTER OF THE SIGN.
- N. NON-ACCESSIBLE DOOR. PROVIDE WARNING SIGN LOCATED IN THE INTERIOR SIDE PER CBC 111338.1.1.1
- O. ALL ROOF MOUNTED MATERIALS SHALL BE FULLY SCREENED FROM PUBLIC VIEW. SEE A/A4.1 OFFICE SECTION.