

KEY NOTES

- MAIN ENTRY
- EMERGENCY EXIT
- METAL CANOPY ABOVE
- DISPLAY AREA WITH EXTERIOR ACCESS FOR MAINTENANCE

PLAN NOTES

- DO NOT SCALE DIMS. WRITTEN DIMENSIONS GOVERN. ALL PARTITION LOCATIONS SHALL BE AS SHOWN ON PARTITION PLAN. IN CASE OF CONFLICT NOTIFY ARCHITECT. PARTITION PLAN BY ARCHITECT TAKES PRECEDENCE OVER ALL OTHER PLANS.
- ALL GYPSUM BOARD PARTITIONS SHALL BE TAPED, SPACKLED AND SANDED SMOOTH WITH NO VISIBLE JOINTS. PATCH AND REPAIR SURFACES TO MATCH ADJACENT OR ADJOINING SURFACES WHERE REQUIRED. ALL SURFACES SHALL BE ALIGNED.
- ALL PARTITIONS ARE DIMENSIONED FROM FINISH FACE OF GWB TO FINISH FACE OF GWB UNLESS OTHERWISE NOTED. ALL DIMENSIONS MARKED "CLEAR" OR "CLF" SHALL BE MAINTAINED AND SHALL ALLOW FOR THICKNESSES OF ALL WALL FINISHES, U.O.N.
- DIMENSIONS MARKED ± MEAN A TOLERANCE NOT GREATER NOR SMALLER THAN 2 INCHES FROM INDICATED DIMENSION, U.O.N. VERIFY FIELD DIMENSIONS EXCEEDING TOLERANCE WITH THE ARCHITECT. SECURE ARCHITECT'S APPROVAL.
- NOTIFY ARCHITECT IN WRITING OF ANY DISCREPANCIES OR CONFLICTS IN THE LOCATION(S) OF NEW CONSTRUCTION. UPON COMPLETION OF PARTITION LAYOUT, NOTIFY ARCHITECT VERIFICATION OF THE LAYOUT TO BE PROVIDED BY THE ARCHITECT PRIOR TO PARTITION INSTALLATION.
- REFER TO SHEET A0.10 FOR ADDITIONAL NOTES, LEGENDS, SYMBOLS, ABBREVIATIONS, AND SCHEDULES.
- DIMENSIONS LOCATING DOORS ARE TO THE INSIDE EDGE OF JAMB, U.O.N.
- "ALIGN" MEANS TO ACCURATELY LOCATE FINISHED FACES IN THE SAME PLANE.
- MODIFY EXISTING SUBSTRATE AS REQUIRED TO RECEIVE NEW FLOORING MATERIALS, THUS PREVENTING NOTICEABLE LUMPS OR DEPRESSIONS.
- ALL WORK SHALL BE ERECTED AND INSTALLED PLUMB, LEVEL, SQUARE AND TRUE.
- REFER TO MILLWORK SHOP DIMS FOR SPECIFIC DETAILS OF COORDINATION BETWEEN DRYWALL/MILLWORK CONDITIONS.
- ALL EXISTING AND NEW FLOOR PENETRATIONS FOR PIPING SHALL BE FULLY PACKED AND SEALED IN ACCORDANCE WITH THE APPLICABLE BUILDING AND FIRE CODES.
- ALL MILLWORK TO BE FASTENED TO THE PARTITION. PROVIDE NON-COMBUSTIBLE BLOCKING FOR ALL MILLWORK NOT SUPPORTED BY FLOOR OR ABOVE 4'-0" HT. ALL CONCEALED LUMBER & BLOCKING TO BE FIRE TREATED.
- GC TO PROVIDE SHOP DIMS FOR CASEWORK.
- ELECTRICAL TO PROVIDE CONVENIENCE OUTLETS EVERY 150 LINEAL FEET IN ALL INTERIOR AREAS. POWER OUTLETS TO BE POWERED TO A SEPARATE CIRCUIT WITH A POWER ON/OFF SWITCH.
- APPLICATION OF DURONOX FLOOR SEALANT/DENSIFIER SOLID SHOULD OCCUR AT TIME OF CONCRETE POUR.
- NO TENANT TO STORE HAZARDOUS MATERIAL LISTED ON CBC TAKES 307.1(1) AND 307.1(2)

WALL LEGEND

- WALL TYPE TAG: REFER TO SHEET A2.00 FOR WALL TYPES ORIENTATION AND CONFIGURATIONS
- INSULATION
- SECTION CONFIGURATION
- PLAN CONFIGURATION
- FEC FIRE EXTINGUISHER (2A-10BC) IN SEMI-RECESSED CABINET PER DETAIL CABINET BY METAL BUILDING SUPPLIER
- FE FIRE EXTINGUISHER (2A-10BC) IN SURFACE MOUNTED BRACKET, MAY NOT PROJECT MORE THAN 4" INTO HALLWAYS AT ANY LOCATION
- 2 HOUR RATED FIRE WALL AROUND ELEVATOR ENCLOSURE AND STAIRWELLS



Copyright © 2021 Magellan Architects  
All rights reserved. The documents prepared by the Architect herein are for the sole use of the client and are not to be reproduced, copied, or transmitted in any form or by any means, electronic or mechanical, including photocopying, recording, or by any information storage and retrieval system, without the express written consent of Magellan Architects. The Architect assumes no responsibility for the use of the documents herein for any purpose other than that intended by the Architect. The Architect shall not be held responsible for any errors or omissions in the documents herein.

**Magellan**  
ARCHITECTS  
10540 Teller Ave. Suite 175  
Tel (949) 515-9600  
www.magellanarchitects.com

**RIALTO SELF STORAGE  
NEW CONSTRUCTION**  
313 SOUTH RIVERSIDE AVENUE,  
RIALTO, CA 92376

REVISIONS		
NO.	DATE	BY
1	4/1/2021	CITY COMMENTS
2	5/5/2021	CITY COMMENTS
3		
4		
5		
ISSUE DATES		
CUP/APP. APPROVAL		
PERMIT SUBMITTAL		
PERMIT RECEIVED		
BID DOCS		
CONSTR. DOCS		

SCALE:	AS NOTED
PLOT DATE:	
CAD FILE:	20-020_A2.10
JOB NUMBER:	20-020
CHECKED:	PA
DRAWN:	CV
STATUS:	SCH. DESIGN

LEVEL 1  
FLOOR PLAN  
**A2.10**



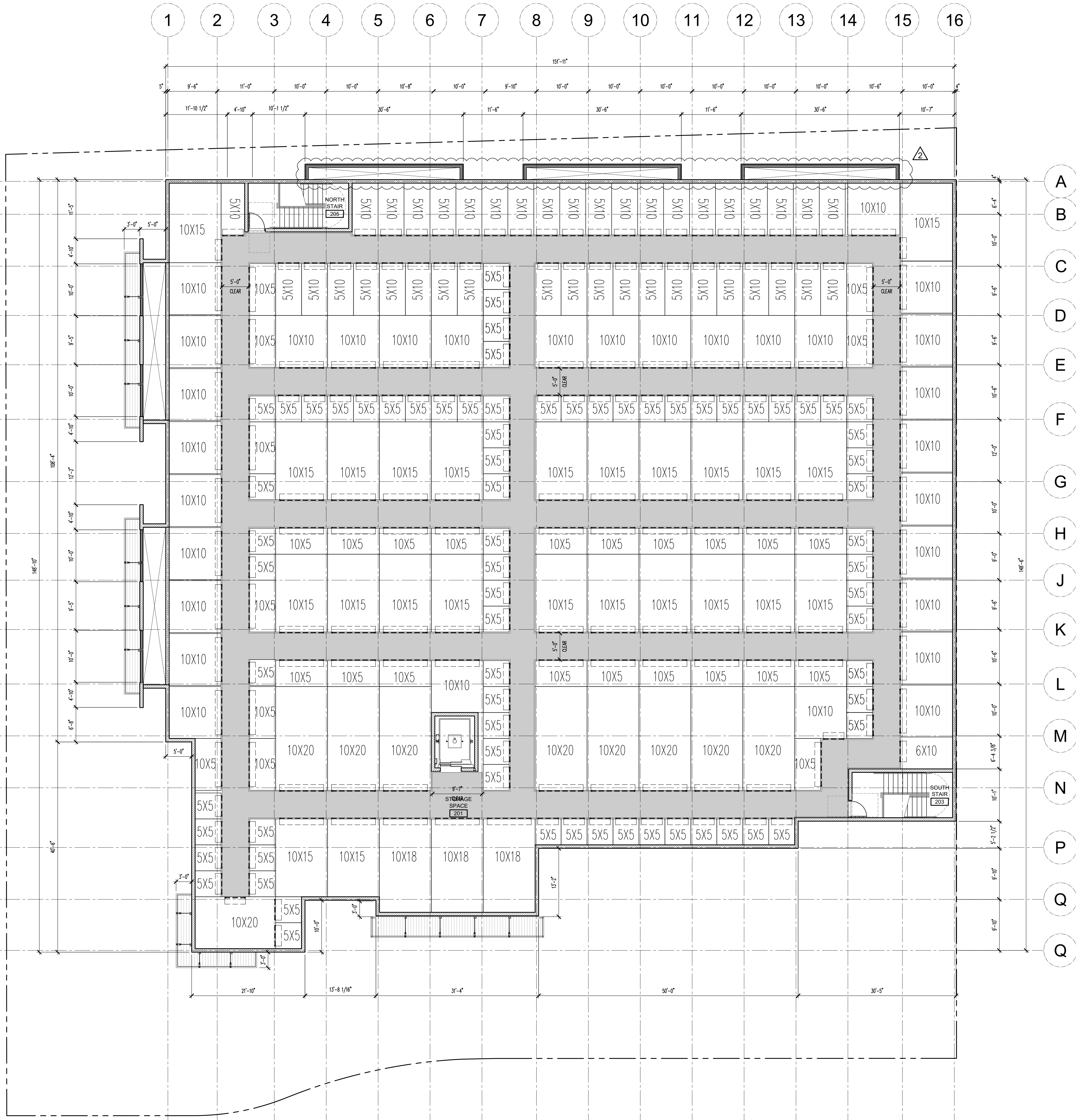

KEY NOTES

- MAIN ENTRY
- EMERGENCY EXIT
- METAL CANOPY ABOVE
- DISPLAY AREA (EXTERIOR ACCESS)
- 
- 
- 
- 

PLAN NOTES

- DO NOT SCALE DIMS. WRITTEN DIMENSIONS GOVERN. ALL PARTITION LOCATIONS SHALL BE AS SHOWN ON PARTITION PLAN. IN CASE OF CONFLICT NOTIFY ARCHITECT. PARTITION PLAN BY ARCHITECT TAKES PRECEDENCE OVER ALL OTHER PLANS.
- ALL GYPSUM BOARD PARTITIONS SHALL BE TAPED, SPACKLED AND SANDED SMOOTH WITH NO VISIBLE JOINTS. PATCH AND REPAIR SURFACES TO MATCH ADJACENT OR ADJOINING SURFACES WHERE REQUIRED. ALL SURFACES SHALL BE ALIGNED.
- ALL PARTITIONS ARE DIMENSIONED FROM FINISH FACE OF GWB TO FINISH FACE OF GWB UNLESS OTHERWISE NOTED. ALL DIMENSIONS MARKED "CLEAR" OR "CLF" SHALL BE MAINTAINED AND SHALL ALLOW FOR THICKNESSES OF ALL WALL FINISHES. U.O.N.
- DIMENSIONS MARKED ± MEAN A TOLERANCE NOT GREATER NOR SMALLER THAN 2 INCHES FROM INDICATED DIMENSION. U.O.N. VERIFY FIELD DIMENSIONS EXCEEDING TOLERANCE WITH THE ARCHITECT. SECURE ARCHITECT'S APPROVAL.
- NOTIFY ARCHITECT IN WRITING OF ANY DISCREPANCIES OR CONFLICTS IN THE LOCATION(S) OF NEW CONSTRUCTION. UPON COMPLETION OF PARTITION LAYOUT, NOTIFY ARCHITECT. VERIFICATION OF THE LAYOUT TO BE PROVIDED BY THE ARCHITECT PRIOR TO PARTITION INSTALLATION.
- REFER TO SHEET A0.10 FOR ADDITIONAL NOTES, LEGENDS, SYMBOLS, ABBREVIATIONS, AND SCHEDULES.
- DIMENSIONS LOCATING DOORS ARE TO THE INSIDE EDGE OF JAMB, U.O.N.
- "ALIGN" MEANS TO ACCURATELY LOCATE FINISHED FACES IN THE SAME PLANE.
- MODIFY EXISTING SUBSTRATE AS REQUIRED TO RECEIVE NEW FLOORING MATERIALS, THUS PREVENTING NOTICEABLE LUMPS OR DEPRESSIONS.
- ALL WORK SHALL BE ERECTED AND INSTALLED PLUMB, LEVEL, SQUARE AND TRUE.
- REFER TO MILLWORK SHOP DIMS FOR SPECIFIC DETAILS OF COORDINATION BETWEEN DRYWALL/MILLWORK CONDITIONS.
- ALL EXISTING AND NEW FLOOR PENETRATIONS FOR PIPING SHALL BE FULLY PACKED AND SEALED IN ACCORDANCE WITH THE APPLICABLE BUILDING AND FIRE CODES.
- ALL MILLWORK TO BE FASTENED TO THE PARTITION. PROVIDE NON-COMBUSTIBLE BLOCKING FOR ALL MILLWORK NOT SUPPORTED BY FLOOR OR ABOVE 4'-0" HT. ALL CONCEALED LUMBER & BLOCKING TO BE FIRE TREATED.
- GC TO PROVIDE SHOP DIMS FOR CASEWORK.
- ELECTRICAL TO PROVIDE CONVENIENCE OUTLETS EVERY 150 LINEAL FEET IN ALL INTERIOR AREAS. POWER OUTLETS TO BE POWERED TO A SEPARATE CIRCUIT WITH A POWER ON/OFF SWITCH.
- APPLICATION OF DURONOX FLOOR SEALANT/DENSIFIER SOLID SHOULD OCCUR AT TIME OF CONCRETE POUR.
- NO TENANT TO STORE HAZARDOUS MATERIAL LISTED ON CBC TAKES 307.1(1) AND 307.1(2)

WALL LEGEND

- WALL TYPE TAG: REFER TO SHEET A2.00 FOR WALL TYPES ORIENTATION AND CONFIGURATIONS
- INSULATION
- SECTION CONFIGURATION
- PLAN CONFIGURATION
- FIRE EXTINGUISHER (2A-10BC) IN SEMI-RECESSED CABINET PER DETAIL CABINET BY METAL BUILDING SUPPLIER
- FIRE EXTINGUISHER (2A-10BC) IN SURFACE MOUNTED BRACKET, MAY NOT PROJECT MORE THAN 4" INTO HALLWAYS AT ANY LOCATION
- 2 HOUR RATED FIRE WALL AROUND ELEVATOR ENCLOSURE AND STAIRWELLS



Copyright © 2021 Magellan Architects  
All rights reserved. The documents prepared by the Architect herein are for the sole use of the client and are not to be reproduced, stored in a retrieval system, or transmitted in any form or by any means, electronic, mechanical, photocopying, recording, or by any information storage and retrieval system, without the express written consent of Magellan Architects. The Architect assumes no responsibility for the use of the documents herein for any purpose other than that intended by the Architect. The Architect shall not be held responsible for any errors or omissions in the documents herein.

**Magellan**  
ARCHITECTS  
10540 Taber Ave. Suite 175  
Tel (949) 515-9600  
www.magellanarchitects.com

**RIALTO SELF STORAGE  
NEW CONSTRUCTION**  
313 SOUTH RIVERSIDE AVENUE,  
RIALTO, CA 92376

REVISIONS		
NO.	DATE	BY
1	4/1/2021	CITY COMMENTS
2	5/5/2021	CITY COMMENTS
3		
4		
5		
ISSUE DATES		
CUP/APP. APPROVAL		
PERMIT SUBMITTAL:		
PERMIT RECEIVED:		
BID DOCS:		
CONSTR. DOCS:		

SCALE:	AS NOTED
PLOT DATE:	
CAD FILE:	20-020_A2.10
JOB NUMBER:	20-020
CHECKED:	PA
DRAWN:	CV
STATUS:	SCH. DESIGN

LEVEL 2  
FLOOR PLAN  
**A2.10**