

Shoppes at Creekside

VARIANCE REQUEST

NOVEMBER 17, 2021

Shoppes at Creekside

Proposal to Replace Existing Sign



Remove existing pylon sign and replace with new pylon sign, encompassing the shopping center identification, Chevron and double-faced digital displays for advertising.

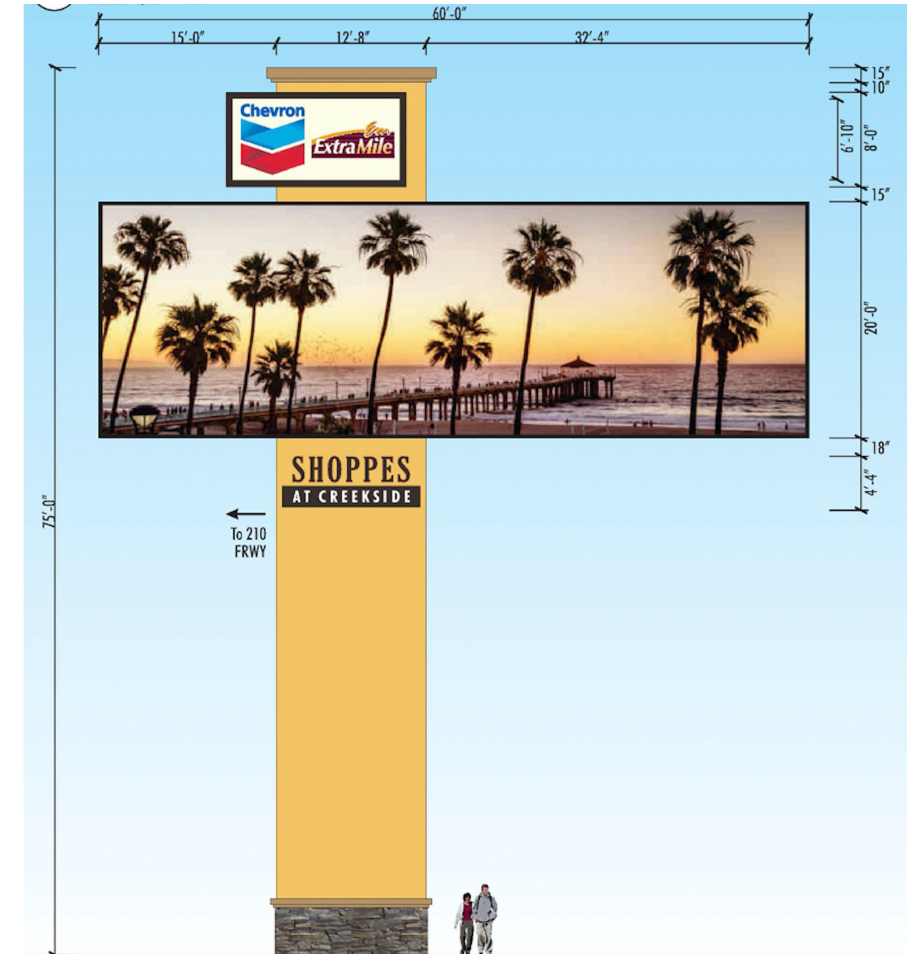

ORIGINAL SIGN



Comparable #1: Bridge to Progress

Original sign featured 20' x 25' digital signs. It was demolished and replaced with 14' x 48' digital signs. The 75' overall height matches that of our Proposal.





Rialto Height Reference

90' tall Pylon sign located directly across from proposed site.

Shoppes at Creekside Site Plan

Existing pylon P2 shall be removed prior to installation of pylon P3

P2

P3

New pylon P3 replaces pylon P2

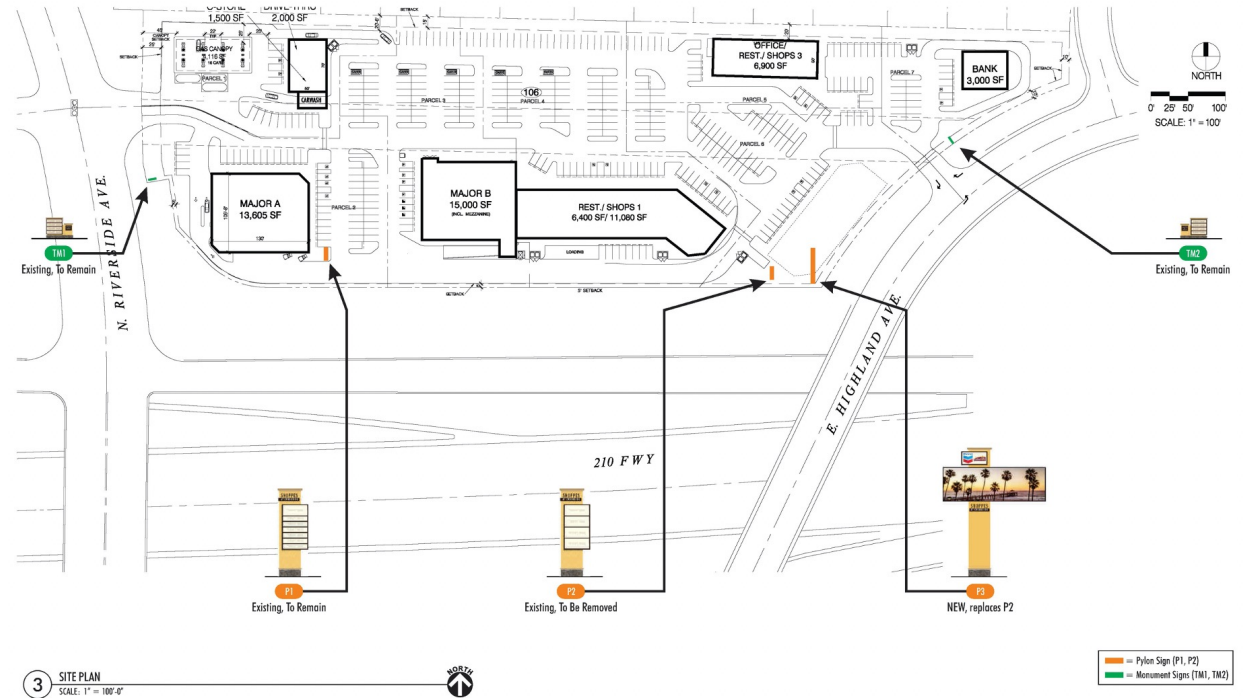

Shoppes at Creekside

West-bound view from 210 Freeway

